



- 01 The equipment is designed to be operated under DC12V. Normal operations are only made when DC12V is supplied. When the supplied power is over than DC12V, the equipment may not be operated accurately. In particular, under low voltage(less than 12V), DC motor output decreases, which leads to lower speed of rotation.
- 02 Please replace cutter on a regular basis, delayed replacement may deteriorate the cutting force, which leads to failure of accurate cutting.
- 03 The cutting effect of the cutter depends on the material of the key blank. Select preferable speed and cutting times to cut hard key blank.
- 04 Take cautions not to drop the machine and keep the machine away from wet.
- 05 Make sure to enter correct key data and input correct key biting number.
- 06 Keep the car engine on while connecting the machine with the cigar jack for using.

Make sure to comply with the followings when using Beta:



Product Catalog



Cautions	01
Standard Package	02
Part Name	03
Power Adapter	04
Specification	04
Consumable Items	05
Cutter	05
Decoder	05
Key Fixation	06
Jaw instruction	09
S1-S4 Jaw	09
Standard Menu	10
Cutter Dimension Adjustment	12
Cutting Depth Adjustment	12
Layered Cutting	12
Jaw Calibration	13
S1-S4 Jaw	13

Search	15
Key Blank Search	16
ID Search	16
Key Decoding	17
Key Cutting	19
Key Photographing	21
Code	23
Progression	25
Duplicate	27
Single Standard Key	27
Double Standard Key	28
Single External Groove Key	29
Double External Groove Key	30
Internal Groove Key	31
Tubular Key	32
Custom Keys	33
Double Standard Key	33
Single Standard Key	35
Single Internal Groove Key	37
Single External Groove Key	39
Double Internal Groove Key	41
Double External Groove Key	43
Dimple Key	45
Tubular Key	47
Device	49
Language	49
Software Upgrade	49
Firmware Upgrade	49
About Us	49
Setting	50
Cut History	51
Favorites	51
Software Activation	52
Download	53
Warranty	54

Cautions

Safety Instructions

- Make sure to observe the followings for using the equipment safely.
- Below information is provided to enhance the user security awareness and prevent property loss. Read the cautions carefully for correct use.
- 🚨 It indicates that you may get injured or damage the equipment if fail to follow the instructions.
- 🚨 It indicates that you will be seriously injured if fail to follow the instructions.

Cautions for Power

- 🚨 Never use damaged power cords or loose plugs or sockets.

Never pull out the plug by tugging the power cord, or touch the metal part of the power plug.

If smoke rises up or abnormal voice sounds when using the equipment, turn off the power right away and contact your dealer or our factory for advice.

- 🚨 Never plug in many power cords in one outlet simultaneously, otherwise the outlet may get too hot and cause fire.

Keep the equipment unplugged when unused for a long time.

Cigar jack fuse may blow out if you connect the equipment with the vehicle cigar jack. In such a case, use a new fuse in 10A or more. You can only connect the equipment with cigar jack while the vehicle engine is running.

Cautions for Installation

- 🚨 Do not install the equipment in a place with oil, smog, moist, dust and water splashing. It may cause electric shock or fire.

Make sure to install the equipment on stable flat surface. The equipment weights about 14kg and generates vibration during operation. If you use the equipment on bumpy surface, it may lead to damages on equipment and injuries on users.

- 🚨 Do not put burning cigarettes or candles on the equipment; Keep the equipment away from heating devices like stoves when installation, otherwise it may get overheated, resulting in equipment failure or cause fire.

Cautions for Usage

- 🚨 The cutter of the equipment spins at high speed during operation. Keep your body or clothing or other things away from the equipment, otherwise the user may get seriously injured by the cutter.

Do not put any tools, water containers, mugs, cups or small metal pieces on the equipment or crumb tray.

Vibration of the equipment and carelessness of the user may cause falling of the above objects, which leads to injuries on the user.

Overheating or electric leakage may lead to fire or equipment failure, it may cause electric shock or fire when the equipment gets wet.

Other cautions

- 🚨 Do not disassemble or modify the equipment. It may cause fire, electric shock and equipment failure. If you need a check-up, adjustment, repair of the equipment, please ask your dealer or contact our factory for advice.

Keep children away from the equipment, their curiosity or carelessness may lead them to be injured.

- 🚨 In winter (sub-zero temperature), the equipment may be unable to work properly. In such a case, the user can increase temperature of working environment. Do not let the temperature of working environment go lower than zero.

Standard Package



📌 Tips: Cutter and decoder are consumable items. Make sure to replace it after a certain period of use.



Beta Key Cutting Machine
Quantity: 1EA
Purpose: Duplicating and cutting keys



S1 Jaw (4-Way Jaw)
Quantity: 1EA
Purpose: Fixing standard keys, laser keys and dimple keys (Dimple cutter and decoder is optional)



1.5mm Cutter
Quantity: 1EA
Purpose: Cutting standard keys and some laser keys



2.0mm Cutter
Quantity: 1EA
Purpose: Cutting most laser keys



45° Decoder
Quantity: 2EA
Purpose: Key decoding tool



Calibration Block
Quantity: 1EA
Purpose: Calibrating jaw



Stopper
Quantity: 1EA
Purpose: Guiding key reference position



M3 Screw
Quantity: 2EA
Purpose: Fixing keys on Side C/D of S1 jaw



M5*10 Sharp Screw
Quantity: 2EA
Purpose: Fixing key jaws on machine



M5 Screw
Quantity: 2EA
Purpose: Fixing cutter and decoder

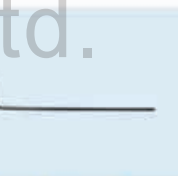

1.5mm L-wrench
Quantity: 1EA
Purpose: Tightening M3 screws

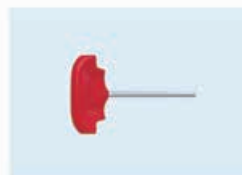

2.5mm T-wrench
Quantity: 1EA
Purpose: Tightening M5 screws



12V Adaptor with Power Cord
Quantity: 1EA
Purpose: Power supply INPUT 100~240V 50/60Hz 3A OUTPUT 12V 12.5A



USB Cable for Upgrade
Quantity: 1EA
Purpose: Machine upgrade



Brush
Quantity: 1EA



Shield
Quantity: 1EA

Part Name

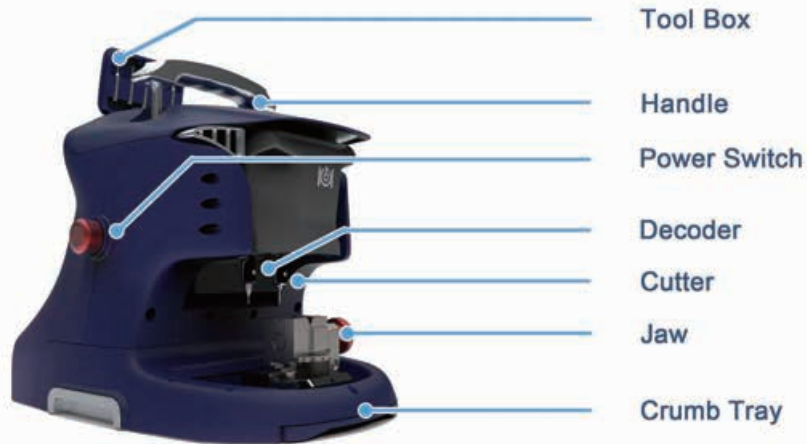

Attention

- Strike, heavy and sharp things may damage the display screen.
- Decoder is consumable item, easy to damage.
- Don't throw or strike decoder casually.
- Kukai is not responsible for decoder damaged in any cases.

Power Adapter

Accessories/Components for Power



① Connect the power adaptor, clockwise twist switch to turn on the equipment, press switch to turn off the equipment.

Specification

Equipment Specification

Power Input Voltage	 DC12V/12.5A
Power	150W
Dimension	270(W) x 300(H) x 370(D)mm
Weight	14kg
Theoretical Accuracy	XY Axis:0.005mm Z Axis:0.0025mm
Spindle Speed	12000+rpm
Working Temperature Range	0-40°C
Working Humidity Range	10-90%
Usage	To cut automobile keys, residential keys, motorcycle keys, dimple keys, tubular keys, FO21 tibbe keys.

Consumable Items

Cutter

- 1.1 Installation
- 1.2 Disassembly



1.1 Installation

Steps for Cutter Installation

- (1) Insert the cutter into the cutter holder and push it to the limit
- (2) Fix M5 screw tightly by turning 2.5mm T-wrench clockwise

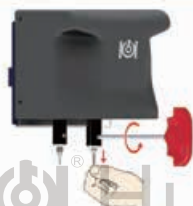

1.2 Disassembly

Steps for Cutter Disassembly:

- (1) Hold the cutter and loosen M5 screw by turning 2.5mm T-wrench counterclockwise.
- (2) Take the cutter out after it looses.



Decoder

- 2.1 Installation
- 2.2 Disassembly

2.1 Installation

Steps for Decoder Installation:

- (1) Insert the decoder into the decoder holder and push it to the limit
- (2) Fix M5 screw tightly by turning 2.5mm T-wrench clockwise



2.2 Disassembly

Steps for Decoder Disassembly:

- (1) Hold the decoder and loosen M5 screw by turning 2.5mm T-wrench counterclockwise.
- (2) Take the decoder out after it looses.



Key Fixation

Tip: Please select correct side of S1 Jaw according to App shown

Shoulder Align

Standard Key



Fix the key at Side C&D with stopper.

Laser Key



Fix the key at Side A&B, no need to use stopper.

Tip Align

Standard Key

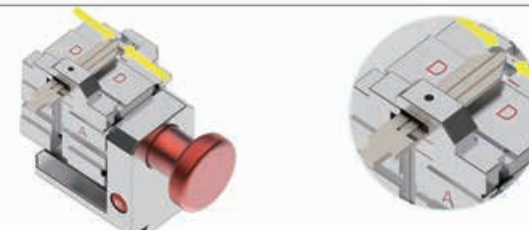

Fix the key at Side C&D, no need to use stopper.

Laser Key



Fix the key at Side A&B, no need to use stopper.

Key Fixation

ⓘ Please avoid below mistakes when fixing the keys

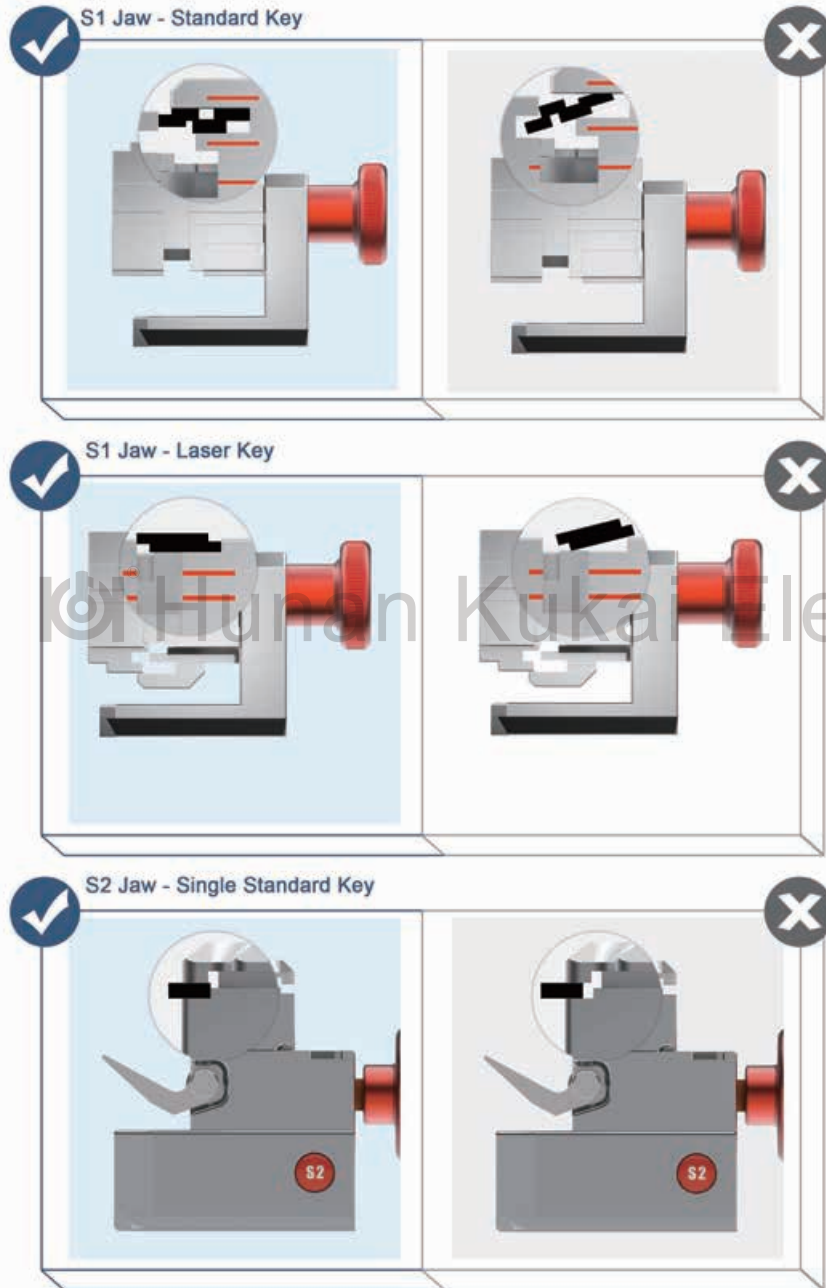

Key Fixation

ⓘ Please avoid below mistakes when fixing the keys

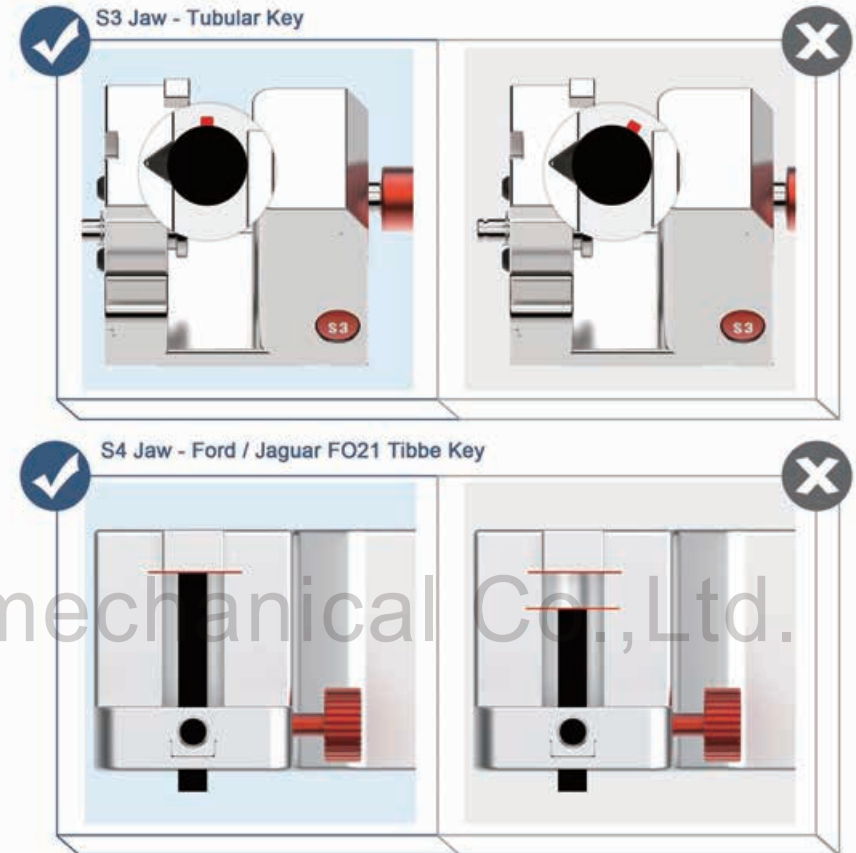

Jaw Instruction

S1
Jaw

Available for
 Double standard keys
 Single internal groove keys
 Single external groove keys
 Double internal groove keys
 Double external groove keys
 Dimple keys



Available for
 Single standard keys

S2
Jaw

S3
Jaw

Available for
 Tubular keys



Available for
 Ford FO21 Tibbe (6 cuts) keys and
 Jaguar FO21 Tibbe (8 cuts) keys

S4
Jaw

Standard Menu

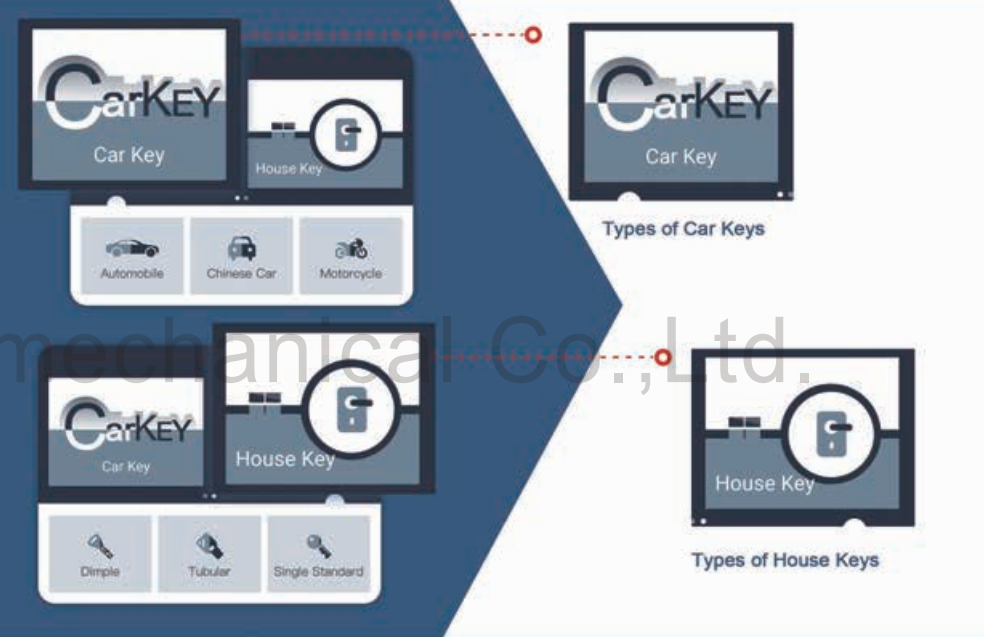
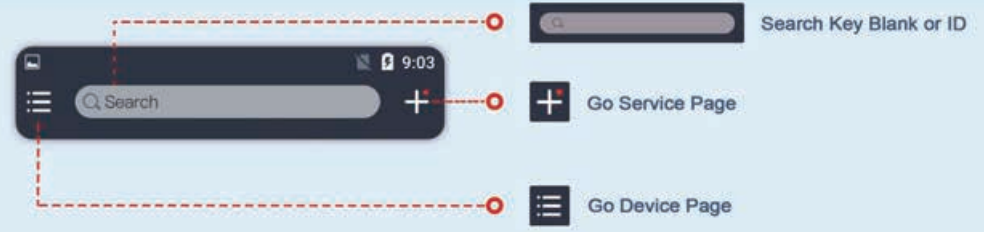

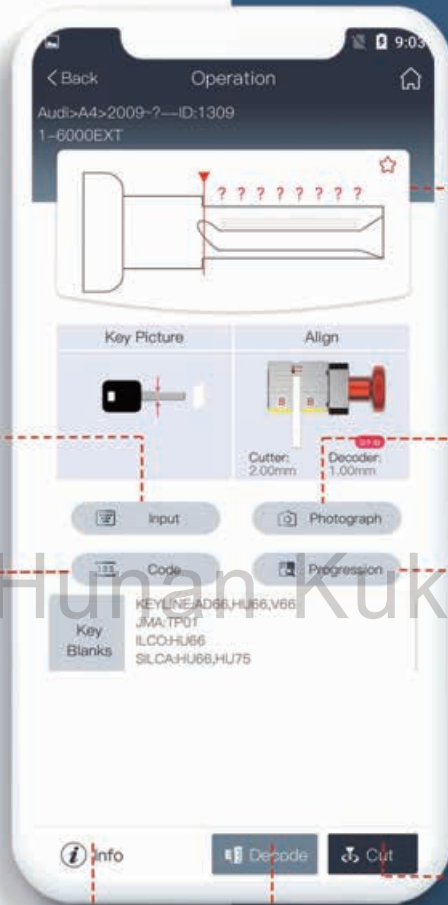

Collect common keys

Input biting numbers

Get biting numbers by key code

Read biting numbers by camera

Input existing biting numbers to get unknown biting number

Cut key

Decode key

Show basic information

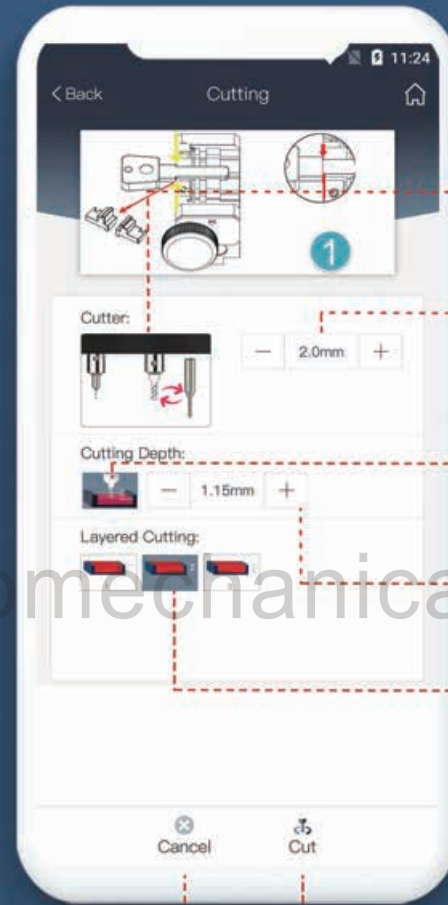

Please insert the cutter shown as picture.



You can adjust the cutter dimension within the range of 2.5mm, based on the actually used cutter.



You can manually set the cutting depth when cutting laser keys.

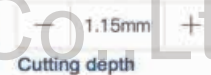

When cutting laser keys, you can choose 1,2 or 3 times to finish the cutting depth. The harder the key blank is, the more times will be needed.

Cut

Start to cut key

Cancel

Cancel the operation

Jaw Calibration

Automobile Key Jaw



Step 1
Choose Calibration



Step 2
Choose corresponding key jaw



Step 3
Change cutter to decoder, place the calibration block and fix jaw tightly, then click "OK" button shown as picture

Step 3
Change cutter to decoder, place the calibration block and fix jaw tightly, then click "OK" button shown as picture

Step 3
Change cutter to decoder, place the calibration block and fix jaw tightly, then click "OK" button shown as picture

Step 3
Change cutter to decoder, place the calibration block and fix jaw tightly, then click "OK" button shown as picture

Jaw Calibration

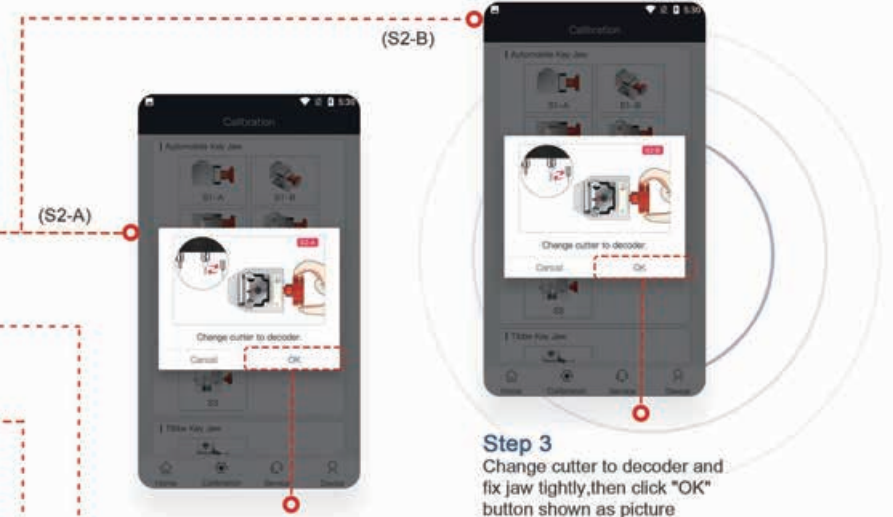

Step 3
Change cutter to decoder and fix jaw tightly, then click "OK" button shown as picture

Step 3
Change cutter to decoder and fix jaw tightly, then click "OK" button shown as picture

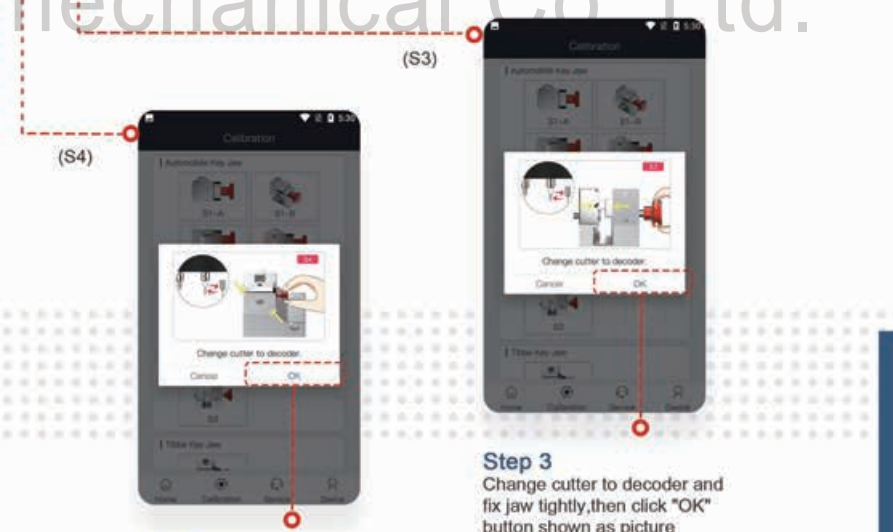

Step 3
Change cutter to decoder and fix jaw tightly, then click "OK" button shown as picture

Step 3
Change cutter to decoder and fix jaw tightly, then click "OK" button shown as picture

Hunan Kukai Electromechanical Co., Ltd.

Search

Example: Key Blank-HU66 / ID-909 (Volkswagen,Audi,Skoda)
 You can search key data by key blank / ID

ⓘ However you have to be familiar with car key blank for using this function

Step 1
Click **Key Blank** button

Step 2
Click "Key Blank" button, then input the key blank number

Step 2
Click "ID" button, then input the ID number

Search



Example: Key Blank-HU66 / ID-909 (Volkswagen,Audi,Skoda)
 You can search key data by key blank / ID

ⓘ However you have to be familiar with car key blank for using this function

Step 3
Choose the corresponding key blank manufacturer

Step 3
Choose the corresponding ID number

Step 4
Input the biting numbers and click "OK" button then "Cut" button

Step 4
Input the biting numbers and click "OK" button then "Cut" button

Key Decoding

Example: Audi-A4-2009-0--ID: 1309



Step 1
Click **Automobile** button in Home Page

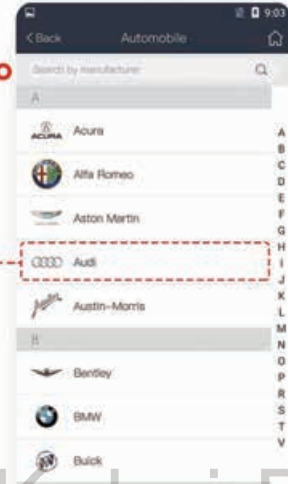

Step 2
Choose "Audi" in the list



Step 3
Choose "A4" in the list



Step 4
Choose the year of manufacturing

Key Decoding

Example: Audi-A4-2009-0--ID: 1309

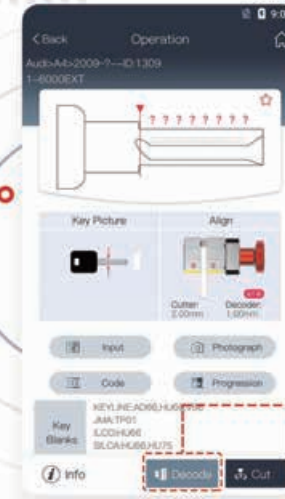

Step 5
Click **Decode** button

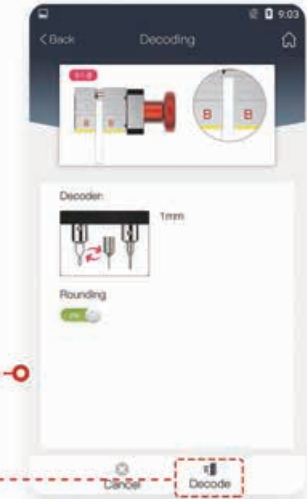

Step 6
1. Confirm key's position
2. Place the decoder shown as picture
3. Click "Decode" button



Step 7
Decoding, wait a moment

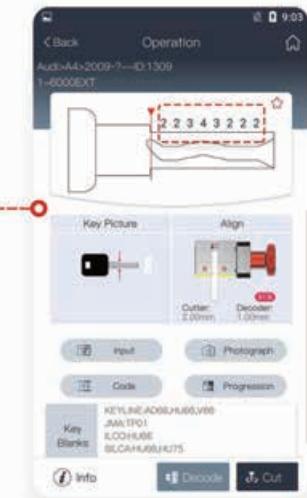

Step 8
Decoding is done

Key Cutting

Example: Audi-Q7-2006~0--ID: 909

Input known biting numbers to cut a key when the original key is lost.



Step 1
Click button in Home Page



Step 2
Choose "Audi" in the list



Step 3
Choose "Q7" in the list

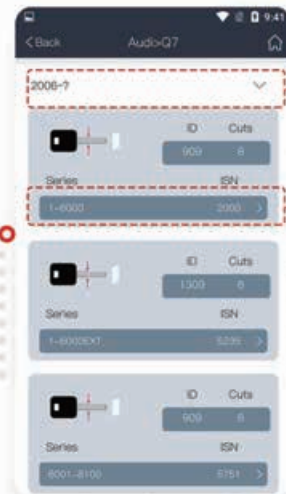

Step 4
Choose the year of manufacturing

Key Cutting

Example: Audi-Q7-2006~0--ID: 909

Input known biting numbers to cut a key when the original key is lost.

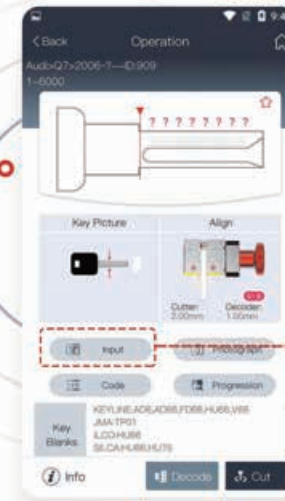

Step 5
Click button



Step 6
Input known biting numbers then click "OK" button

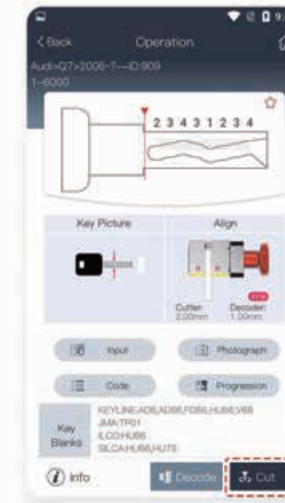

Step 7
Check if the biting numbers are correct or not, then click button

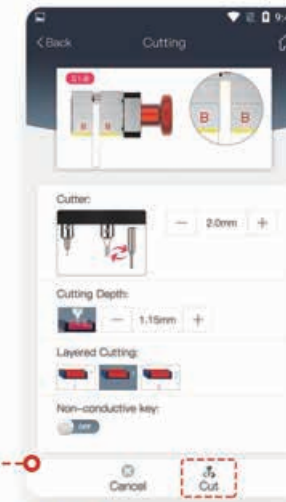

Step 8

1. Fix a new key blank shown as picture
2. Insert cutter at the right side
3. Click button to cut key after confirmed

Key Photographing

Example: Ford-Focus

Please make sure the camera is on before using this function.

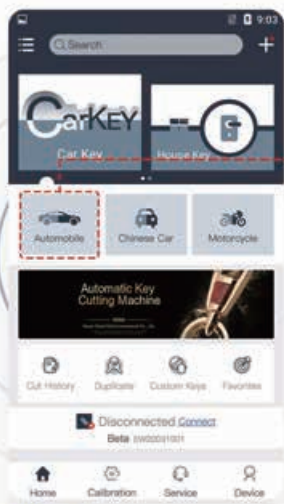

Step 1
Click **Automobile** button in Home Page

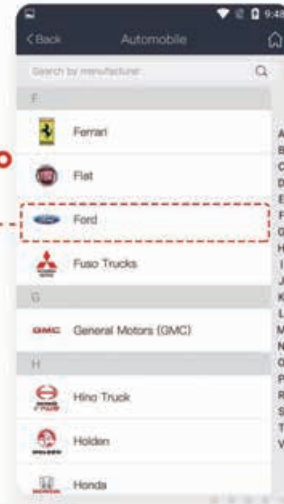

Step 2
Choose "Ford" in the list



Step 3
Choose "Focus" in the list



Step 4
Choose the year of manufacturing

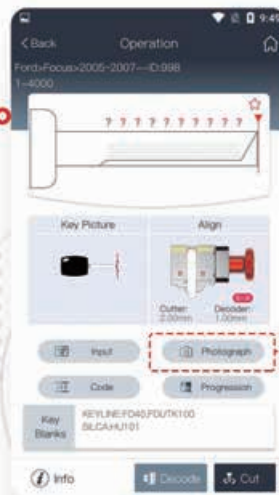

Step 5
Click **Photograph** button

Key Photographing

Example: Ford-Focus

Please make sure the camera is on before using this function.



Step 6
Put the key vertically in designated area, then take a picture



Step 7
Adjust the key picture in designated area by clicking "Rotating" / "Zooming" / "Moving" button

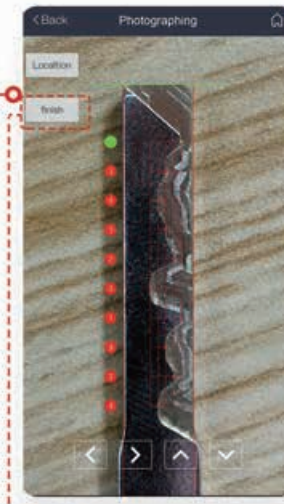

Step 8
Confirm the key space and key biting number, then click "Finish" button to finish adjustment

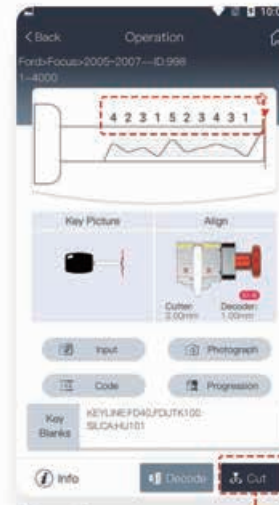

Step 9
Click "Cut" button to start cutting

Example: Honda Accord-2003~2006--ID: 982

How to cut a key when original key is lost

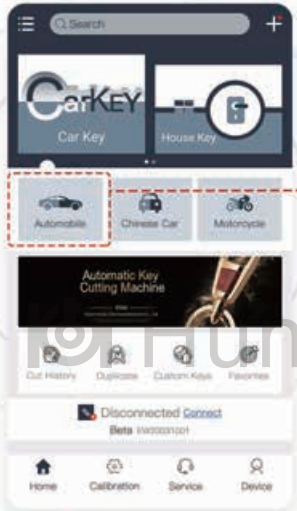

Step 1
Click **Automobile** button in Home Page



Step 2
Choose "Honda" in the list



Step 3
Choose "Accord" in the list

Example: Honda Accord-2003~2006--ID: 982

How to cut a key when original key is lost



Step 4
Choose the year of manufacturing

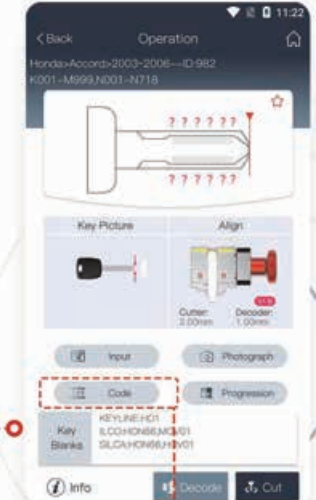

Step 5
Click **Code** button



Step 6
Input the code "M081" and click "Search" to get the biting numbers

Progression

Example: Audi-Q7-2006~0--ID: 909



Step 1
Click **Automobile** button in Home Page

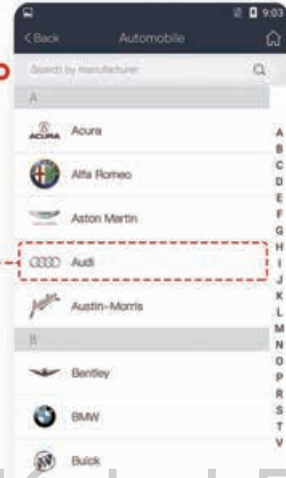

Step 2
Choose "Audi" in the list



Step 3
Choose "Q7" in the list

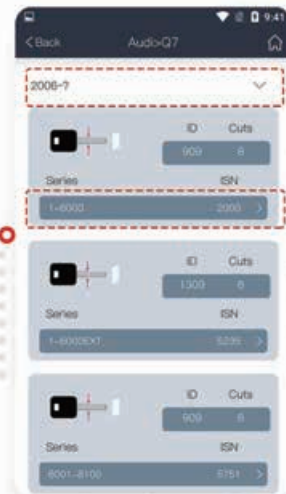

Step 4
Choose the year of manufacturing

Progression

Example: Audi-Q7-2006~0--ID: 909

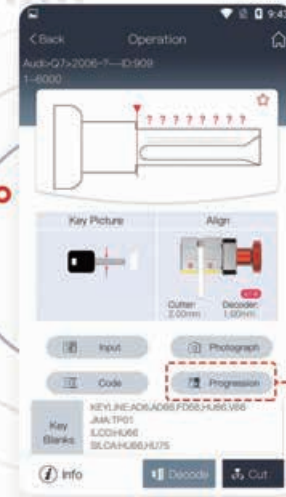

Step 5
Click **Progression** button



Step 6
Example: Input known biting numbers "234321" and keep unknown biting numbers as "?" in the input box



Step 7
Make sure the biting numbers are correct, then click "Search" button



Step 8
Review search results and choose the corresponding one you need

Duplicate

Single Standard Key

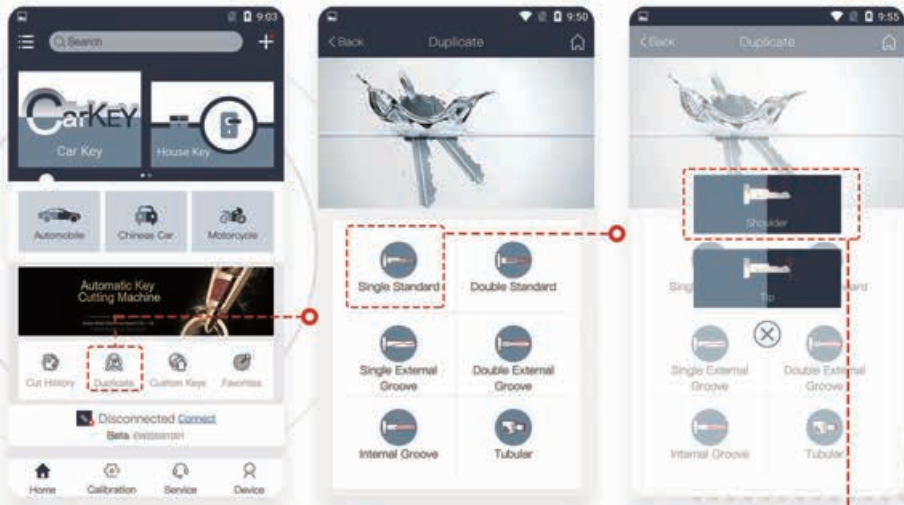

Step 1
Click "Duplicate" button in Home Page

Step 2
Click "Single Standard" button

Step 3
Click "Shoulder" button

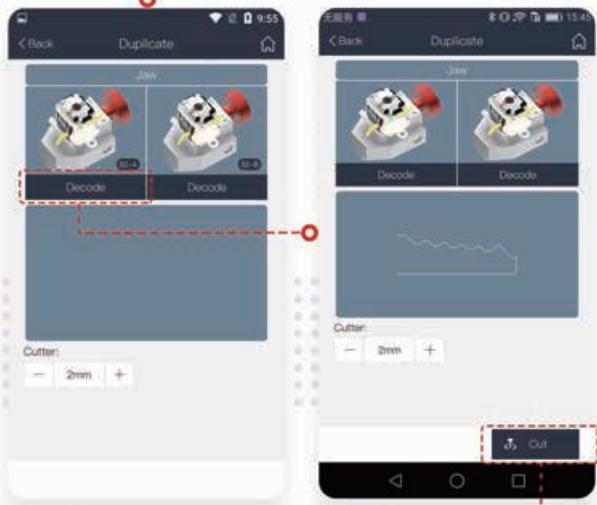

Step 4
Click "Jaw S2-A" button to start duplicating

Step 5
Click "Cut" button after duplicating is done

Duplicate

Double Standard Key

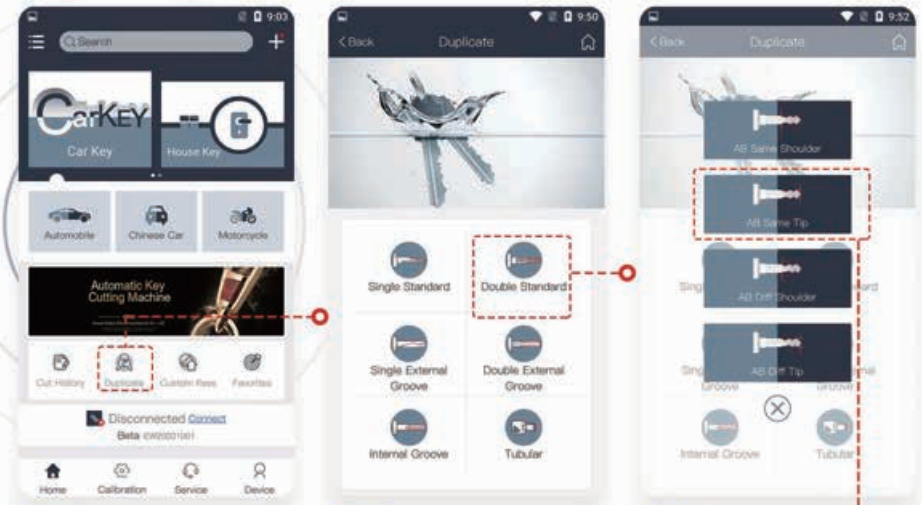

Step 1
Click "Duplicate" button in Home Page

Step 2
Click "Double Standard" button

Step 3
Click "AB Same Tip" button

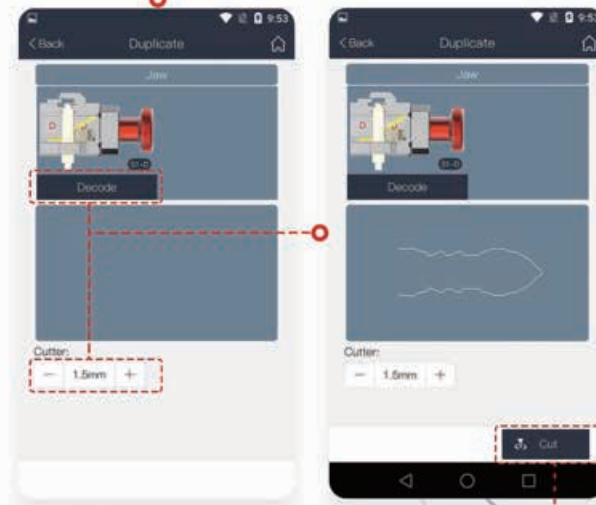

Step 4
Adjust cutter diameter value if need and click "Jaw S1-D" to start duplicating

Step 5
Click "Cut" button after duplicating is done

Duplicate

Single External Groove Key

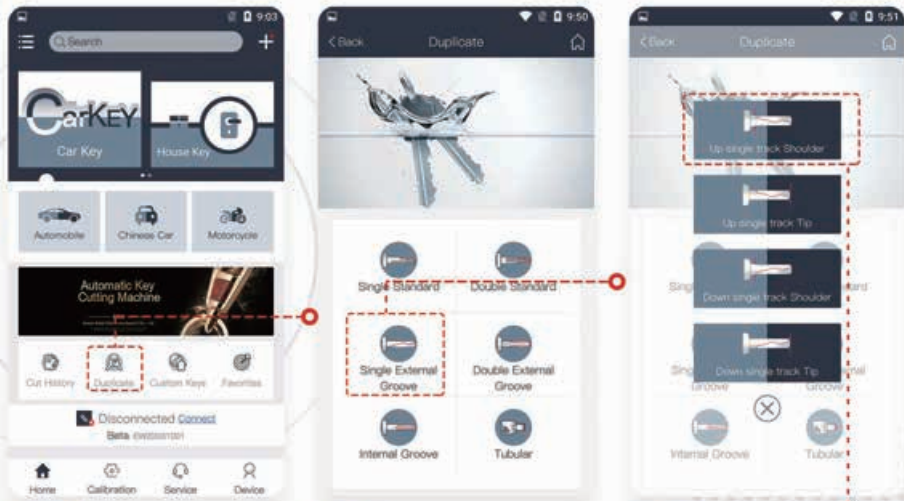

Step 1
Click "Duplicate"
button in Home Page

Step 2
Click "Single External Groove"
button

Step 3
Click "Up Single Track
Shoulder" button



Step 4
Adjust cutter diameter value if
need and click "Jaw S1-B" to start
duplicating

Step 5
Click "Cut" button after duplicating
is done

Duplicate

Double External Groove key

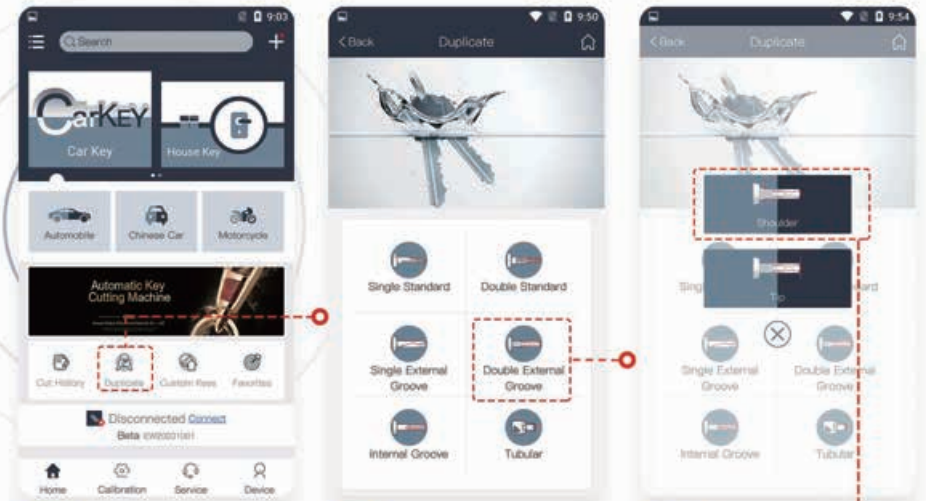

Step 1
Click "Duplicate"
button in Home Page

Step 2
Click "Double External Groove"
button

Step 3
Click "Shoulder" button

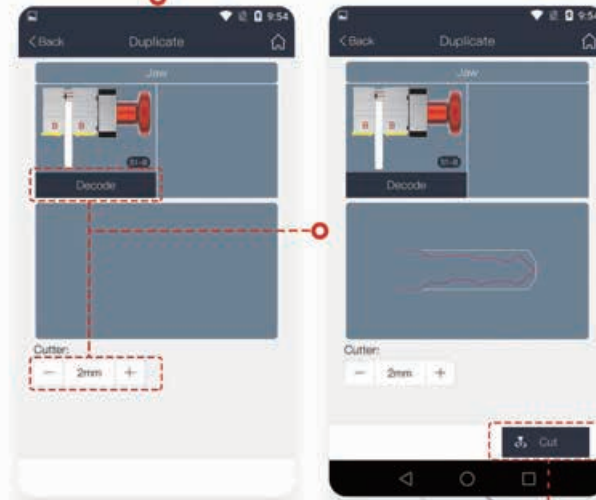

Step 4
Adjust cutter diameter value if
need and click "Jaw S1-B" to start
duplicating

Step 5
Click "Cut" button after duplicating
is done

Duplicate

Internal Groove Key

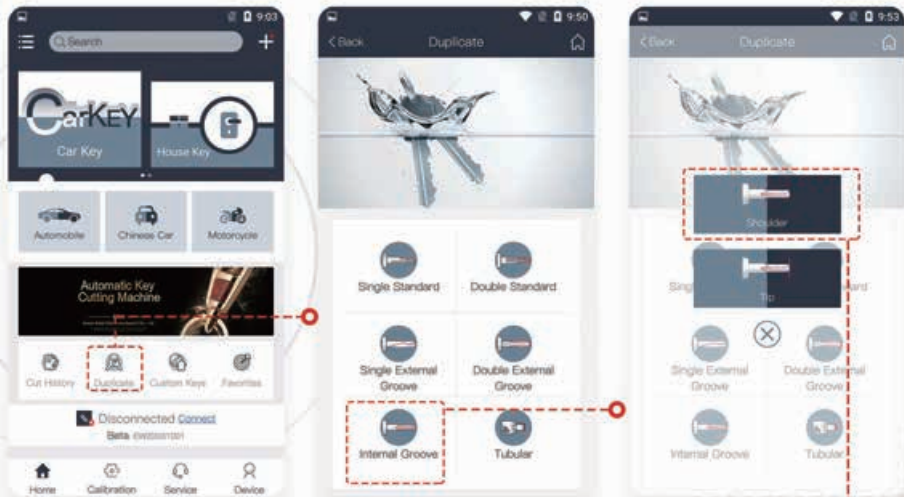

Step 1
Click "Duplicate" button in Home Page

Step 2
Click "Internal Groove" button

Step 3
Click "Shoulder" button

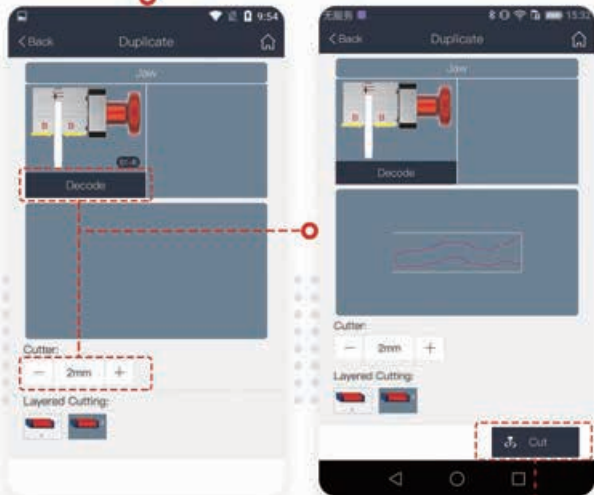

Step 4
Adjust cutter diameter value if need and click "Jaw S1-B" to start duplicating

Step 5
Click "Cut" button after duplicating is done

Duplicate

Tubular Key

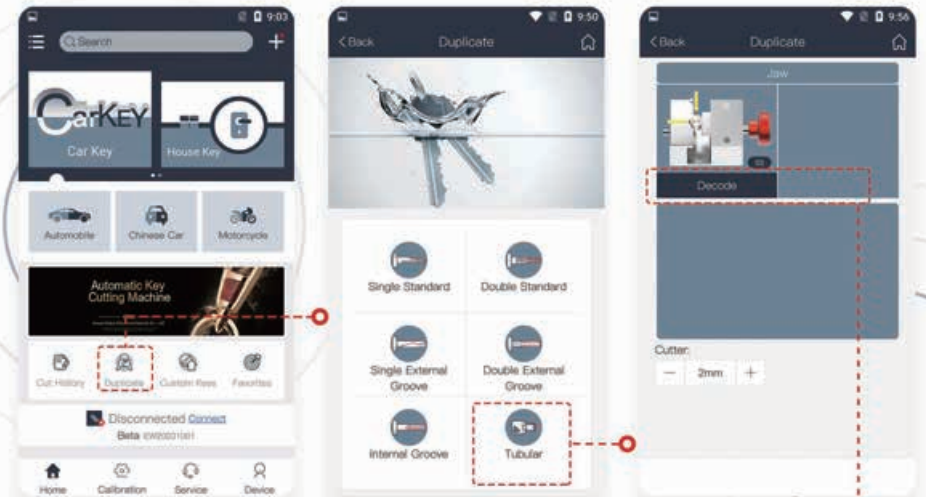

Step 1
Click "Duplicate" button in Home Page

Step 2
Click "Tubular" button

Step 3
Click "Jaw S3" button to start duplicating



Step 4
Click "Cut" button after duplicating is done

Tips: 1.All above about "Duplicate" is just examples showing you how to do , please select correctly according to the key you actually have.

2.The default cutter diameter value is 2.0mm in Beta. If you don't use 2.0mm cutter, please adjust it within the range of 2.5mm, based on the actually used cutter.

Custom Keys

Double Standard Key



Step 1

Click "Custom Keys" button in Home Page

Step 2

Click "+" button

Step 3

Click "Double Standard" and "Next" button

Custom Keys

Double Standard Key



Step 7

Input the parameters in depth and click "Next" button

Step 8

Input the parameters in width and click "Next" button

Step 9

Choose correct "Jaw S1-D" and click "Next" button

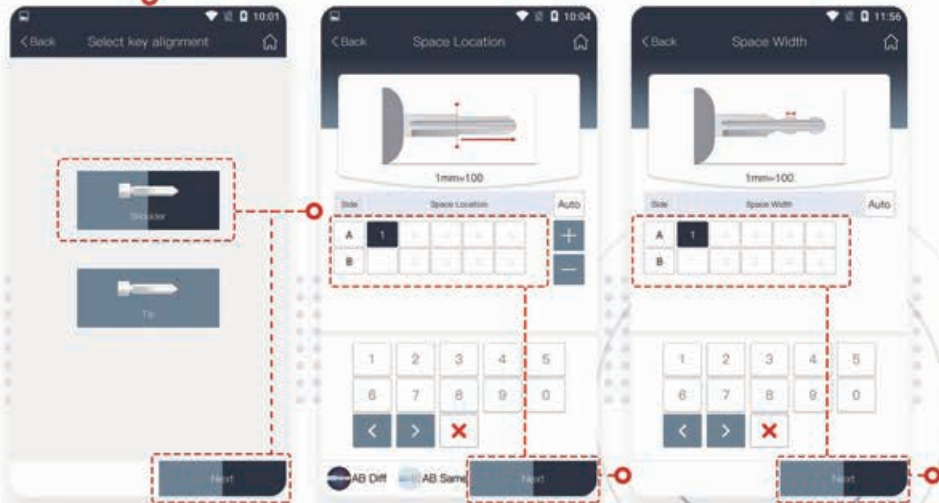

Step 4

Click "Shoulder" and "Next" button

Step 5

Input the parameters in space location and click "Next" button

Step 6

Input the parameters in space width and click "Next" button

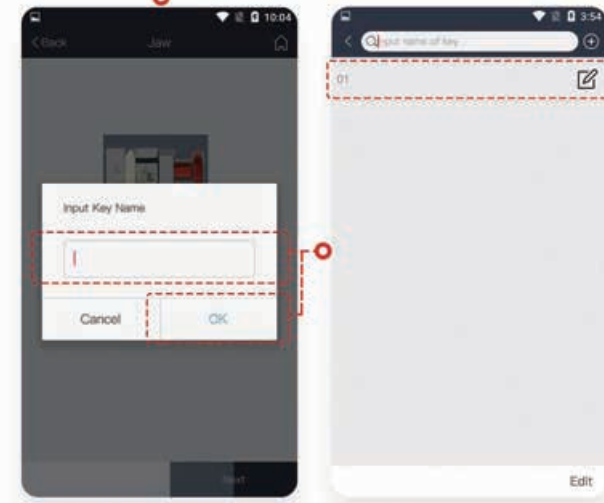

Step 10

Name the new key data and click "OK" button

Step 11

Review the key data you just added

Custom Keys

Single Standard Key



Step 1

Click "Custom Keys" button in Home Page

Step 2

Click "+" button

Step 3

Click "Single Standard" and "Next" button

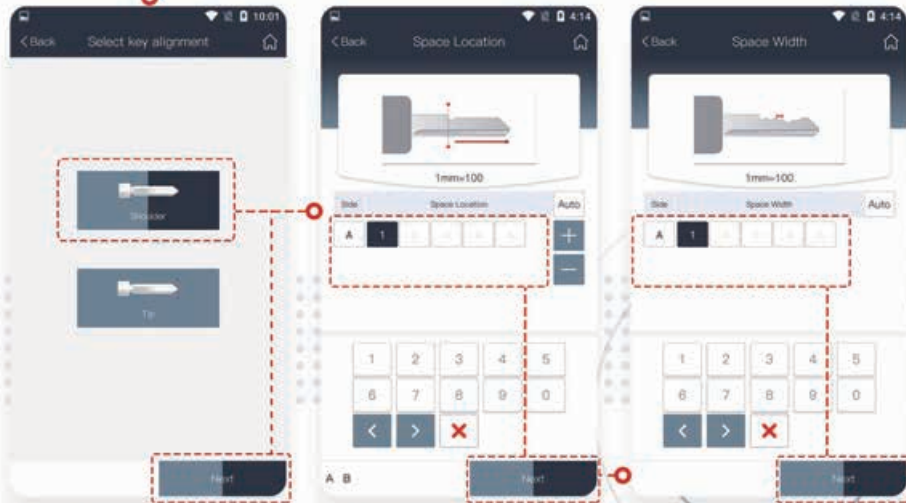

Step 4

Click "Shoulder" and "Next" button

Step 5

Input the parameters in space location and click "Next" button

Step 6

Input the parameters in space width and click "Next" button

Custom Keys

Single Standard Key



Step 7

Input the parameters in depth and click "Next" button

Step 8

Input the parameters in width and click "Next" button

Step 9

Name the new key data and click "OK" button



Step 10

Review the key data you just added

Custom Keys

Single Internal Groove Key



Step 1

Click "Custom Keys" button in Home Page

Step 2

Click "+" button

Step 3

Click "Single Internal Groove Key" and "Next" button

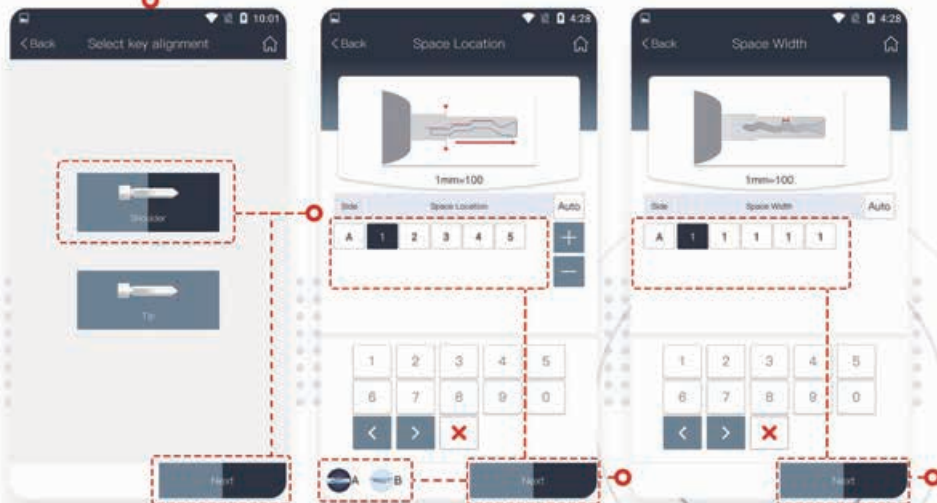

Step 4

Click "Shoulder" and "Next" button

Step 5

Choose Side "A" and input the parameters in space location and click "Next" button

Step 6

Input the parameters in space width and click "Next" button

Custom Keys

Single Internal Groove Key



Step 7

Input the parameters in depth and click "Next" button

Step 8

Input the parameters in width/ thickness/ cut depth/ groove/ guide, and click "Next" button

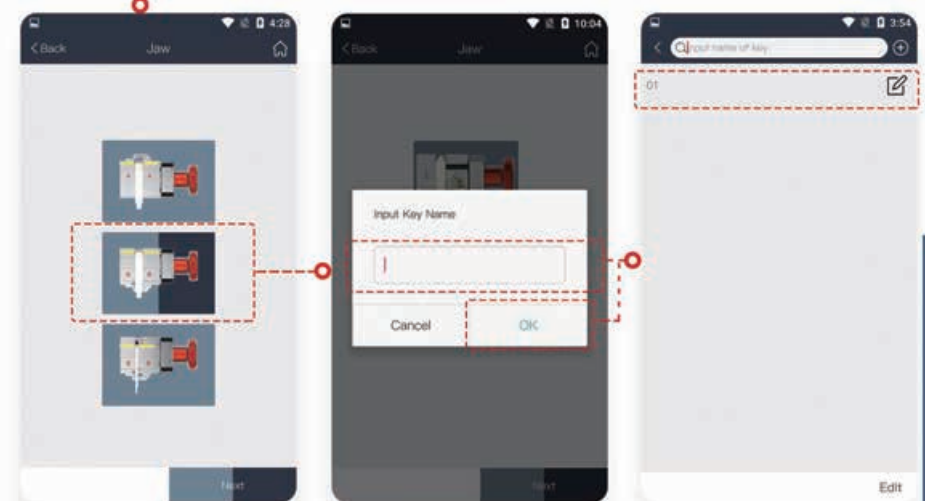

Step 9

Choose correct "Jaw S1-B" and click "Next" button

Step 10

Name the new key data and click "OK" button

Step 11

Review the key data you just added

Custom Keys

Single External Groove Key

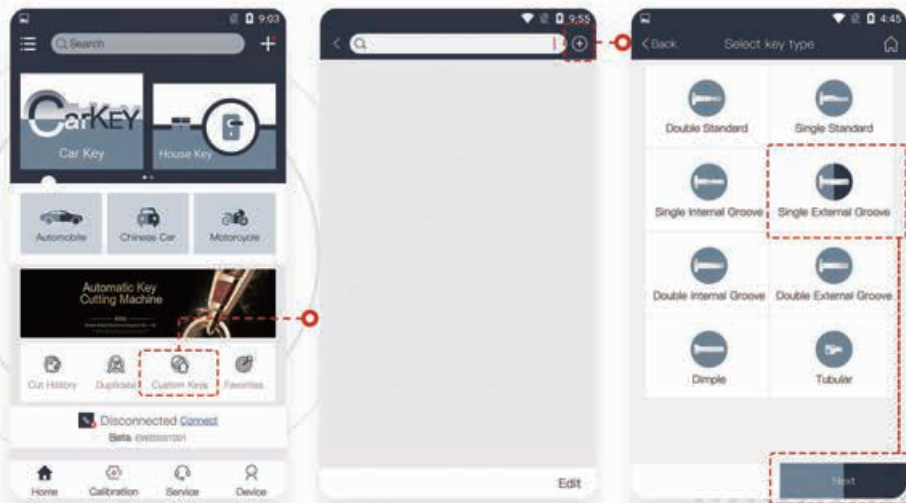

Step 1

Click "Custom Keys" button in Home Page

Step 2

Click "+" button

Step 3

Click "Single External Groove" and "Next" button

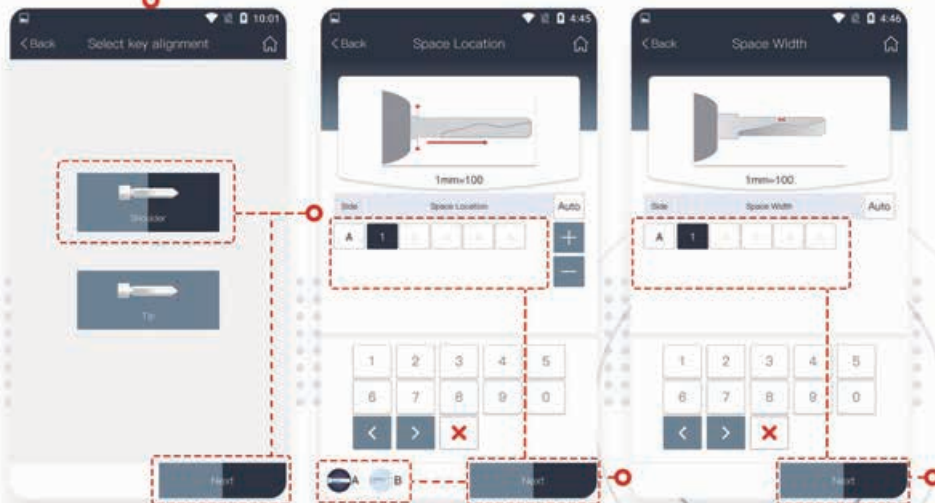

Step 4

Click "Shoulder" and "Next" button

Step 5

Choose Side "A" and input the parameters in space location and click "Next" button

Step 6

Input the parameters in space width and click "Next" button

Custom Keys

Single External Groove Key



Step 7

Input the parameters in depth and click "Next" button

Step 8

Input the parameters in width/ thickness/ cut depth/ guide/ nose and click "Next" button

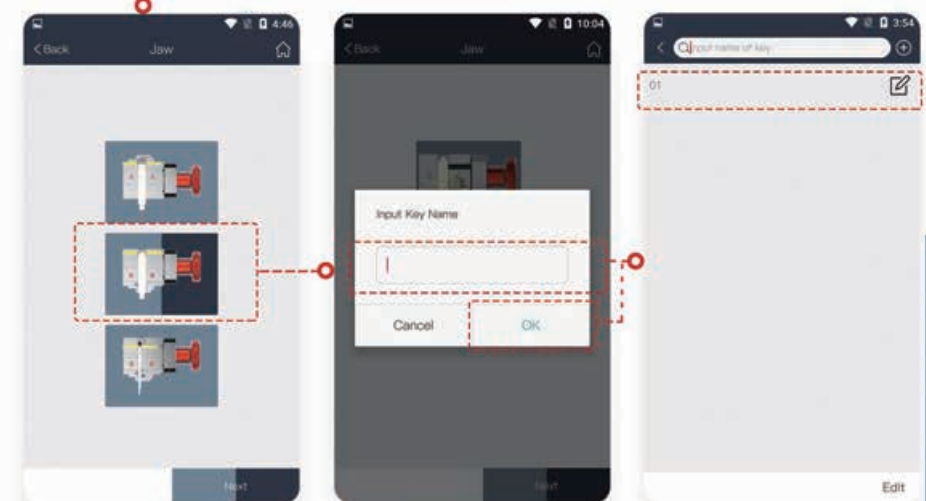

Step 9

Choose correct "Jaw S1-B" and click "Next" button

Step 10

Name the new key data and click "OK" button

Step 11

Review the key data you just added

Custom Keys

Double Internal Groove Key



Step 1

Click "Custom Keys" button in Home Page

Step 2

Click "+" button

Step 3

Click "Double Internal Groove" and "Next" button

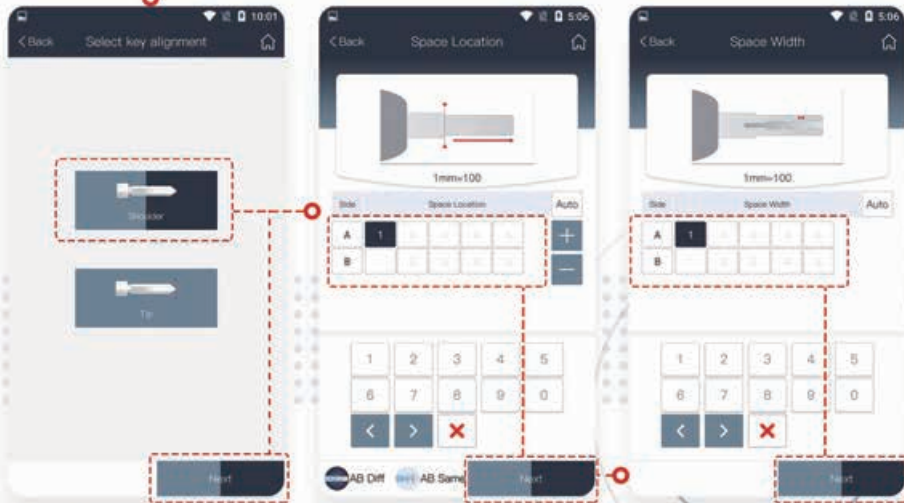

Step 4

Click "Shoulder" and "Next" button

Step 5

Input the parameters in space location and click "Next" button

Step 6

Input the parameters in space width and click "Next" button

Custom Keys

Double Internal Groove Key

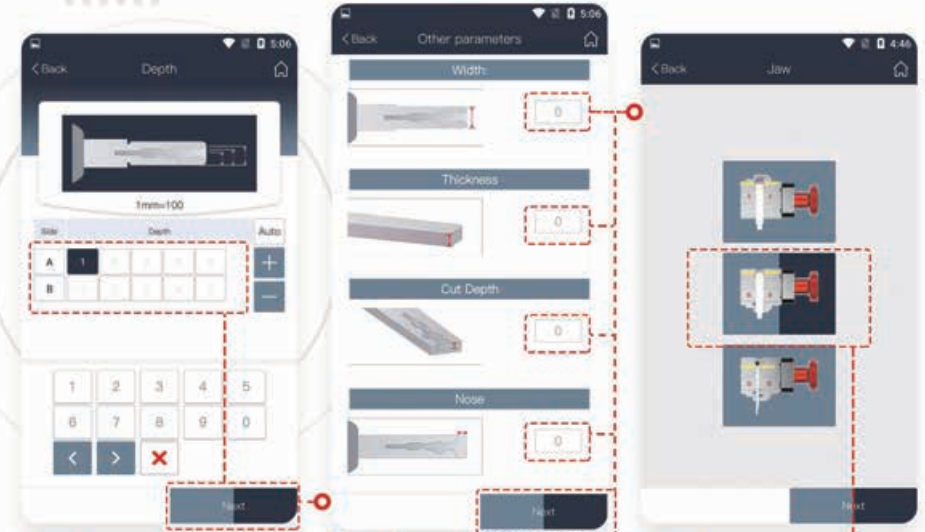

Step 7

Input the parameters in depth and click "Next" button

Step 8

Input the parameters in width/thickness/ cut depth/ nose and click "Next" button

Step 9

Choose correct "Jaw S1-B" and click "Next" button

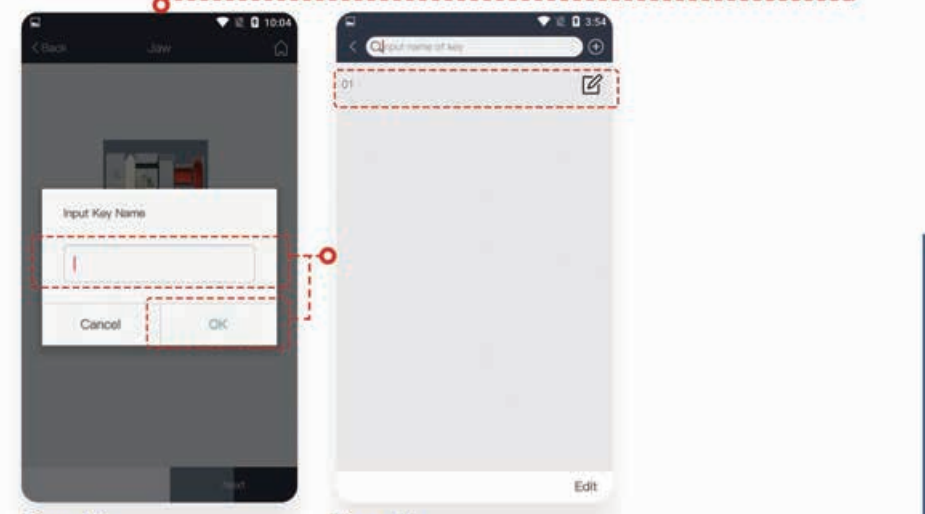

Step 10

Name the new key data and click "OK" button

Step 11

Review the key data you just added

Custom Keys

Double External Groove Key

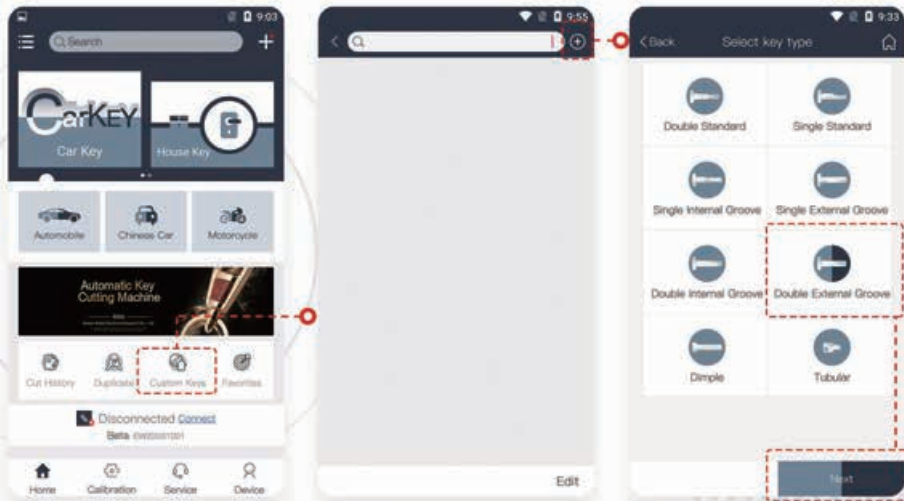

Step 1

Click "Custom Keys" button in Home Page

Step 2

Click "+" button

Step 3

Click "Double External Groove" and "Next" button

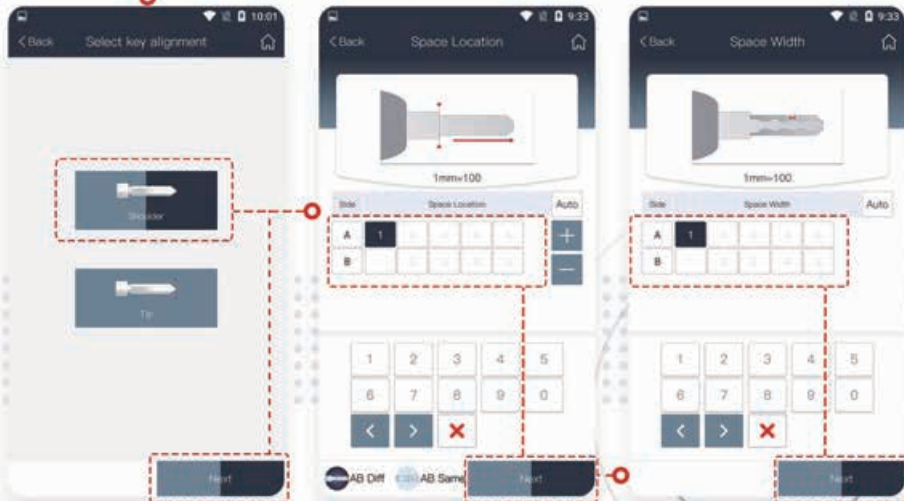

Step 4

Click "Shoulder" and "Next" button

Step 5

Input the parameters in space location and click "Next" button

Step 6

Input the parameters in space width and click "Next" button

Custom Keys

Double External Groove Key

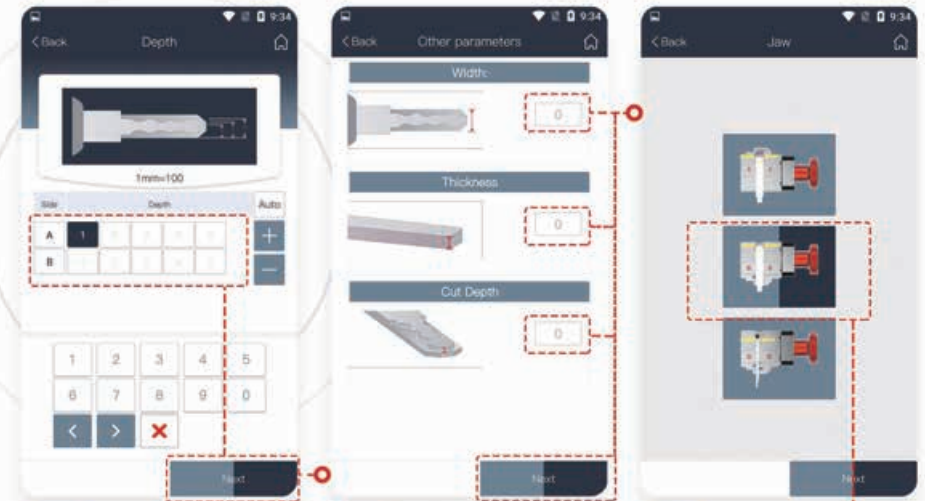

Step 7

Input the parameters in depth and click "Next" button

Step 8

Input the parameters in width/thickness/ cut depth and click "Next" button

Step 9

Choose correct "Jaw S1-B" and click "Next" button

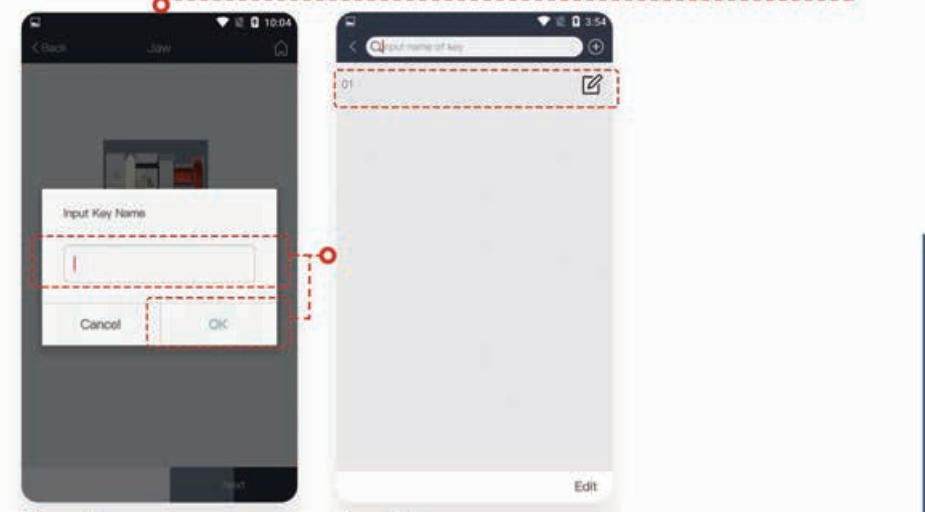

Step 10

Name the new key data and click "OK" button

Step 11

Review the key data you just added

Custom Keys

Dimple Key

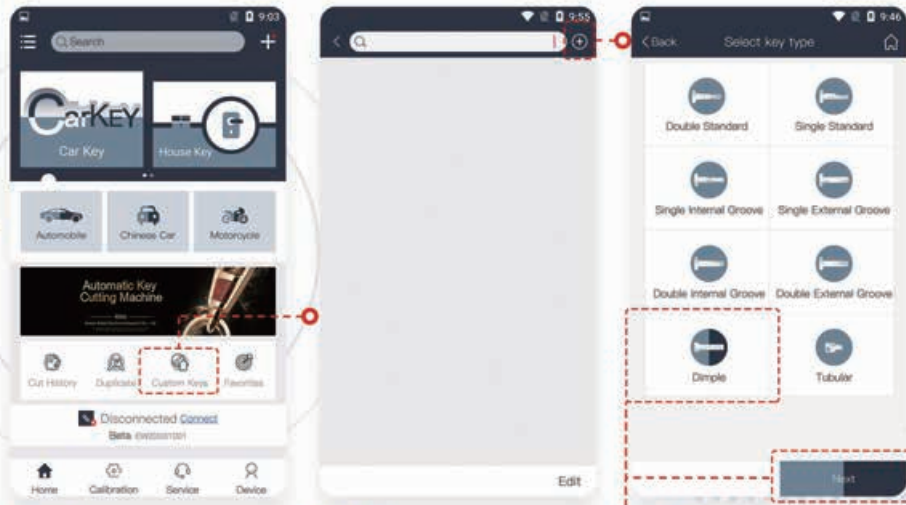

Step 1

Click "Custom Keys" button in Home Page

Step 2

Click "++" button

Step 3

Click "Dimple" and "Next" button

Custom Keys

Dimple Key

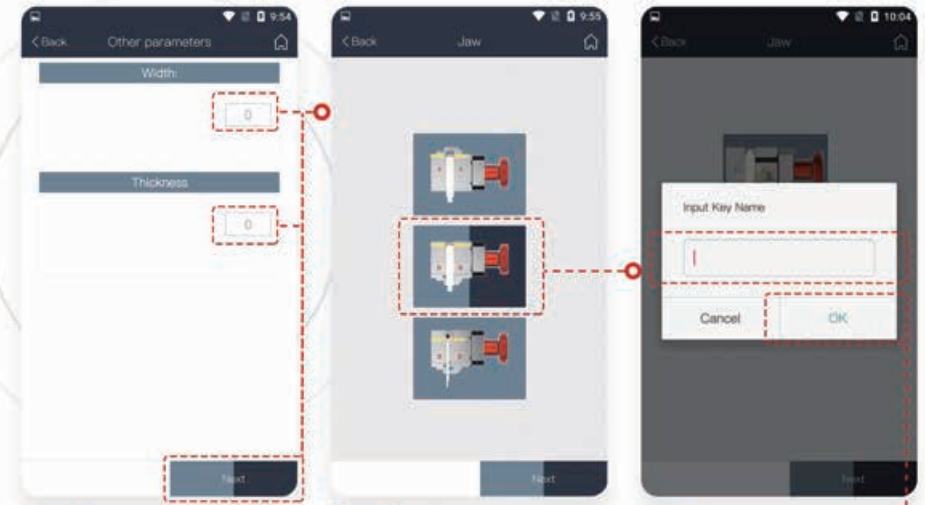

Step 7

Input the parameters in width/thickness and click "Next" button

Step 8

Choose correct "Jaw S1-B" and click "Next" button

Step 9

Name the new key data and click "OK" button



Step 4

Click "Shoulder" and "Next" button

Step 5

Input the parameters in space location and click "Next" button

Step 6

Input the parameters in depth and click "Next"



Step 10

Review the key data you just added.

Custom Keys

Tubular Key

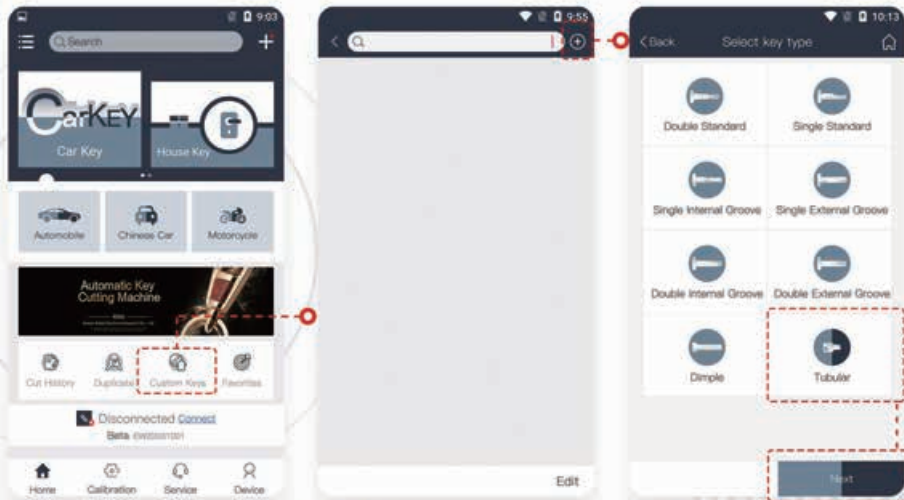

Step 1

Click "Custom Keys" button in Home Page

Step 2

Click "+" button

Step 3

Click "Tubular" and "Next" button

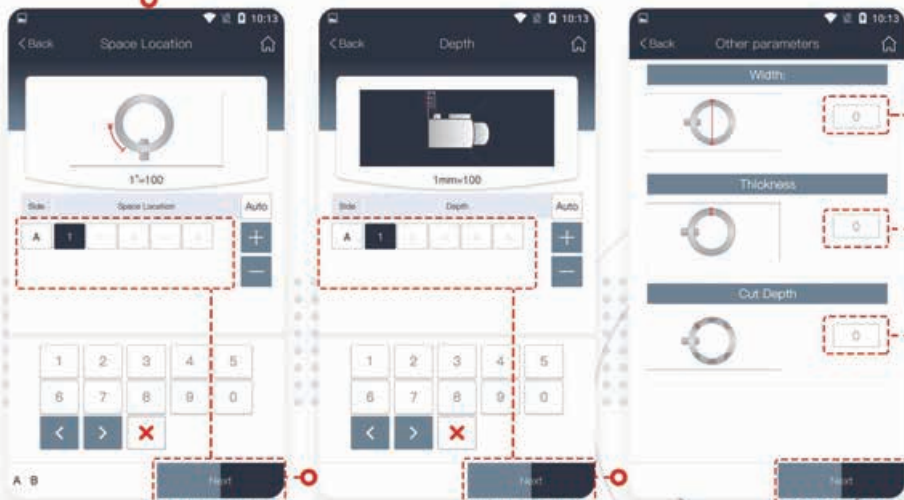

Step 4

Input the parameters in space location and click

Step 5

Input the parameters in depth and click "Next" button

Step 6

Input the parameters in width/ thickness/ cut depth and click "Next" button

Custom Keys

Tubular Key

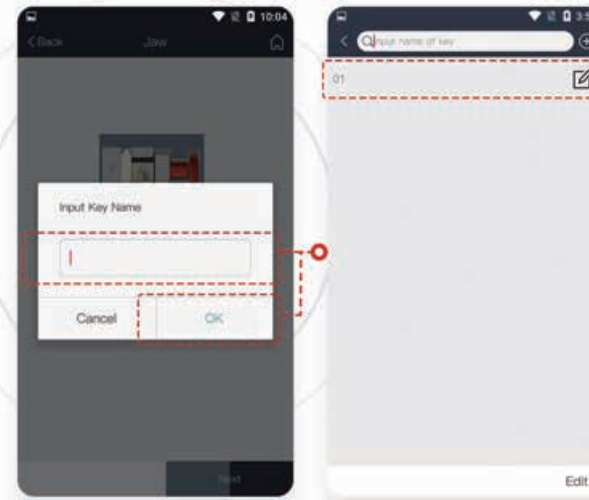

Step 7

Name the new key data and click "OK" button

Step 8

Review the key data you just added.

Tip: All above about "Custom Keys" is just examples showing you how to do, please select correctly according to the key drawing you actually have.

Language / Software Upgrade / Firmware Upgrade / About Us



Enter "Device" Page

Hunan Kukai Electromechanical Co., Ltd.

Language

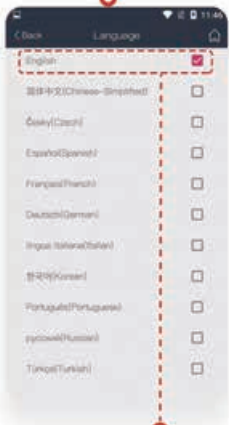

Choose the language you need

Software Upgrader



Click "Upgrade" button to upgrade your equipment

Firmware Upgrade



Wait for upgrade progress to 100% to finish firmware upgrade.

About Us



Review the details of About Us

Setting



Open shield when cutting keys.
Close shield when cutting keys.



Click "+", "-" button to change the cutting speed



Click "On" or "Off" button to control spindle motor rotation

Cut History / Favorites

Cut History / Favorites



Step 1
Click  button



Step 2
You can check the keys you cut before.

Step 1
Click  button



Step 2
You can check what keys you saved before.

Software Activation

Software Activation

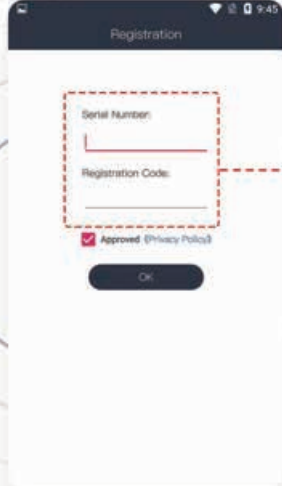
Registration

Serial Number:

Registration Code:

Approved (Privacy Policy)

OK

Step 1

Open the software and enter serial number and registration code to log in.



Registration

Serial Number:
E23456789

Registration Code:
C0123456

Approved (Privacy Policy)

OK

Step 3

Click "OK" button and complete the software activation.



Step 2

Find the label under the handle of Beta, where your serial number and registration code are printed.

Download

- App Download
- Supporting Android and iOS system

Step 1

Open the link on your PC or smart phone:

<http://app.kkkcut.com/SPL-downloadBetaEN.html>



Step 2

Please scan corresponding QR Code by "QR Reader APP" or camera in smart phone



Warranty

Customer Information			
Product Model		Purchased Date	
Customer name		Company Name	
Telephone		Address	
Address			
Dealer Name		Company Name	
Telephone		Address	
Invalid if tear up			

In principle, please contact dealer or manufacturer timely for the defective product

Product Name: Key Cutting Machine Product Model: Beta

The machine warranty is 12 months from the purchased date from manufacturer. Below is the details:

- Warranty Product: Beta Key Cutting Machine (except consumables and accessories)
- Warranty: 12 months from the purchased date from manufacturer. If the purchase date can't be confirmed, warranty is 13 months from production date.
- Some cases not free in warranty time:
 - Malfunctions caused by wars or natural disasters (fire, salt damages, gas, rainstorms or floods);
 - Normal abrasions for consumables;
 - Malfunctions caused by power off or wrong connection;
 - Malfunctions caused by external factors instead of machine itself;
 - Malfunctions caused by others instead of maintenances or reassembling by engineers from our company;
 - Malfunctions by improper operations from customers.
- Free service
Except above cases, malfunctions caused by other reasons are eligible to free service within warranty.
- With regard to other items not stated here, our company will abide by [rules of compensations against damages for customers]