



DeepL

Subscribe to DeepL Pro to translate larger documents.  
Visit [www.DeepL.com/pro](https://www.DeepL.com/pro) for more information.

Remocon

# CATALOG CONTROL OF ACCESS CONTROL

v.1.0



NEW



## GENERAL INDEX

Electronic Handle	pg. 4
Electronic Handle without Fingerprint	pg. 8
Electronic Cylinder	p. 10
Wall Reader	p. 14
Bluetooth Module	pg. 18
Accessories	p. 22





## ELECTRONIC HANDLE



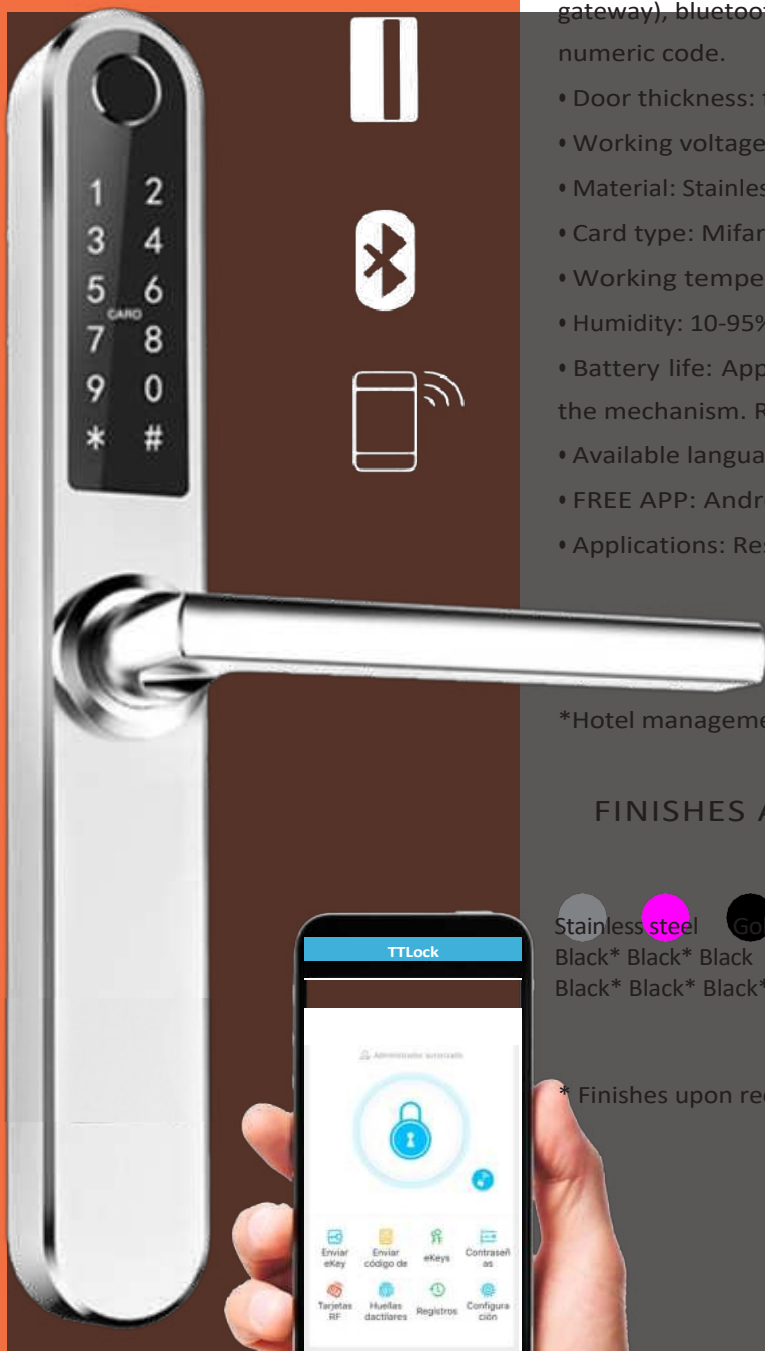

Ref. MEHTPB-MT35  
MEHTPB-MT50  
MEHTPB-MD50  
MEHTPB-MD60  
MEHTPB-MD60

- Full control through: Wi-Fi (it is necessary to install a WiFi gateway), bluetooth APP, biometric fingerprint, proximity card, numeric code.
- Door thickness: from 30mm to 80mm.
- Working voltage: 6V (4 batteries type AAA 1,5V).
- Material: Stainless steel 304.
- Card type: Mifare 13.56 MHz.
- Working temperature: -20°C - 70°C
- Humidity: 10-95% - IP rating: IP55
- Battery life: Approximately 10,000 opening / closing operations of the mechanism. Resetting without disassembling the lock.
- Available languages: Spanish, English, French, Portuguese...
- FREE APP: Android and IOS.
- Applications: Residences, Apartments, Offices, Hotels.  
(need management software), AirBNB, Shops, Gyms, .....

\*Hotel management software available.

Stainless steel Gold\* Gold\* Black\* Black\* Black\* Black\* Black\* Black\*  
Black\* Black\* Black Black\* Black\* Black\* Black\* Black\* Black\* Black  
Black\* Black\* Black\* Black

- \* Finishes upon request



## Technical Characteristics

Material: Galvanized steel sheet

Material front: Stainless steel SUS304

Nut material: Stainless steel SUS304

Anti-card: YES Reversible:

YES Anti-panic: YES

Anti-panic function: By turning the inner handle, the door opens even if the mechanical/electronic privacy is activated.

Wheelbase: 72/85 mm (depending on model)

Entry: 60/50/35 (depending on model). Code

Capacity: Up to 20,000 users Backlit Panel

Estimated battery life: 3 years in standby mode.

Consumption: 20μA in stand-by mode

Can be installed on door widths from 33 mm Security opening via Micro USB power supply and with key.

Lock  
Reversible  
panic lock  
supplied

Ref.

MEHTPB-MT35

Ref.

MEHTPB-MT50  
MEHTPB-MD50

MEHTPB-MD60

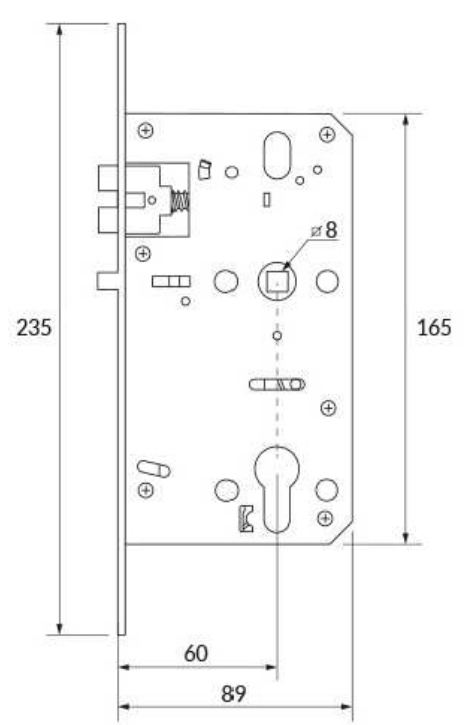
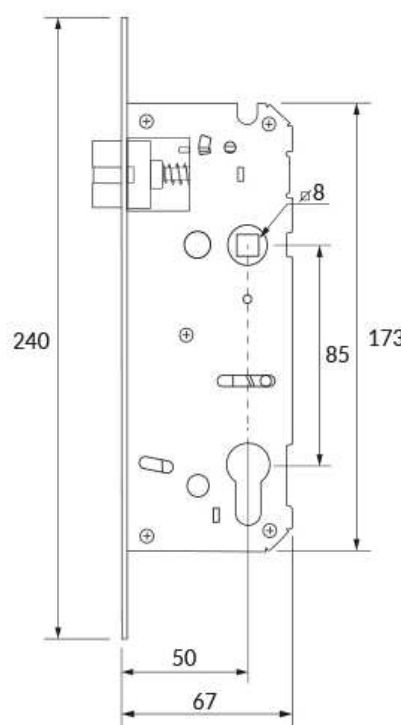
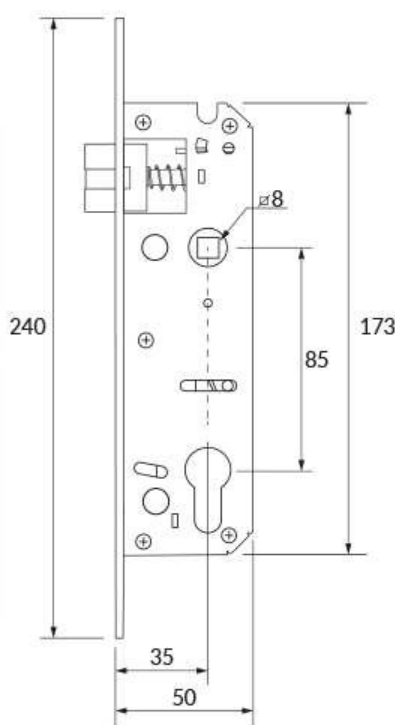
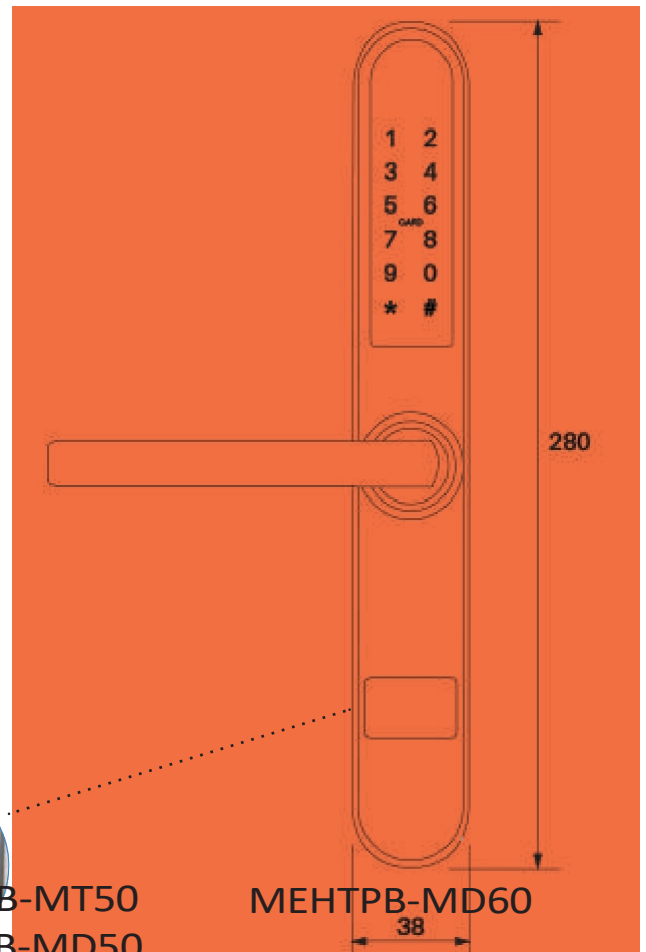

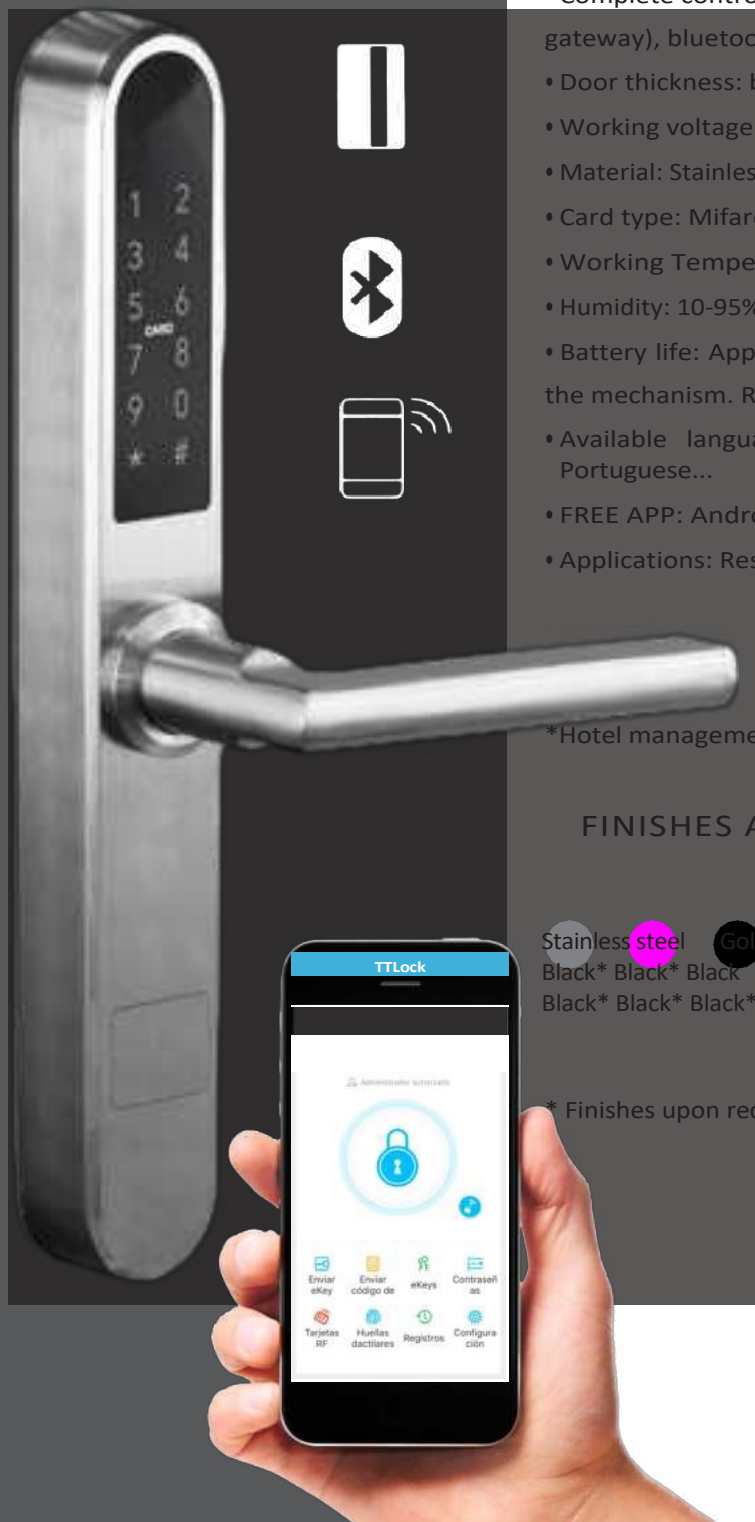

Ref. METPB-MT35  
METPB-MT50  
METPB-MD50  
METPB-MD60  
METPB-MD60

- Complete control through: Wi-Fi (it is necessary to install a WiFi gateway), bluetooth APP, proximity card, numerical code.
- Door thickness: between 30mm. to 80mm.
- Working voltage: 6V (4 batteries type AAA 1,5V).
- Material: Stainless steel 304.
- Card type: Mifare 13,56 MHz.
- Working Temperature: -20°C - 70°C.
- Humidity: 10-95% - IP Rating: IP55
- Battery life: Approximately 10,000 opening / closing operations of the mechanism. Resetting without disassembling the lock.
- Available languages: English, Spanish, French, Portuguese, French, Portuguese...
- FREE APP: Android and IOS
- Applications: Residences, Apartments, Offices, Hotels.  
(need management software), AirBNB, Shops, Gyms, .....

\*Hotel management software available.

[illegible]

\* Finishes upon request



## Technical Characteristics

Material: Galvanized steel sheet

Material front: Stainless steel SUS304

Nut material: Stainless steel SUS304

Anti-card: YES Reversible:

YES Anti-panic: YES

Anti-panic function: By turning the inner handle, the door opens even if the mechanical/electronic privacy is activated.

Wheelbase: 72/85 mm (depending on model)

Entry: 60/50/35 (depending on model). Code

capacity: Up to 20,000 users Backlit Panel

Estimated battery life: 3 years in standby mode

Consumption: 20μA in standby mode

Can be installed on door widths from 33 mm Security opening via Micro USB power supply and with key.

Lock  
Reversible  
panic lock  
supplied

Ref.

**METPB-MT35**

Ref.

**METPB-MT50**  
**METPB-MD50**  
**METPB-MD50**

Ref.

**METPB-MD60**

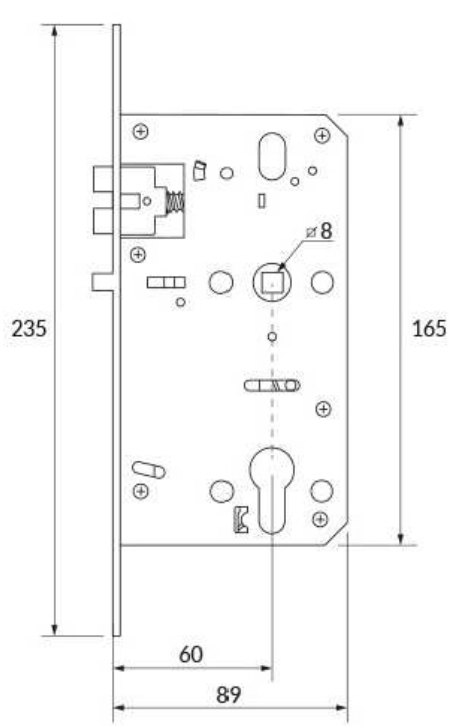
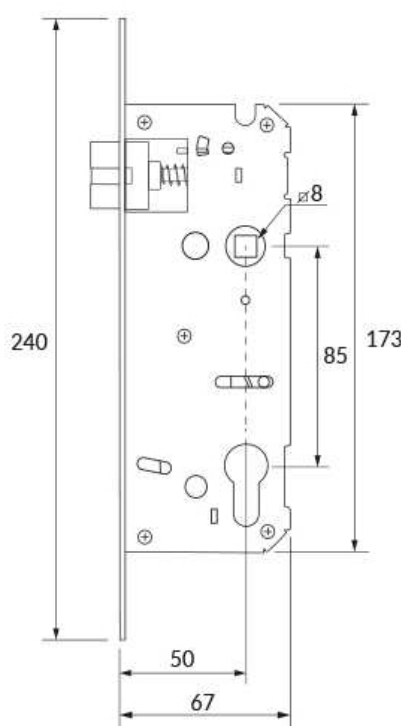
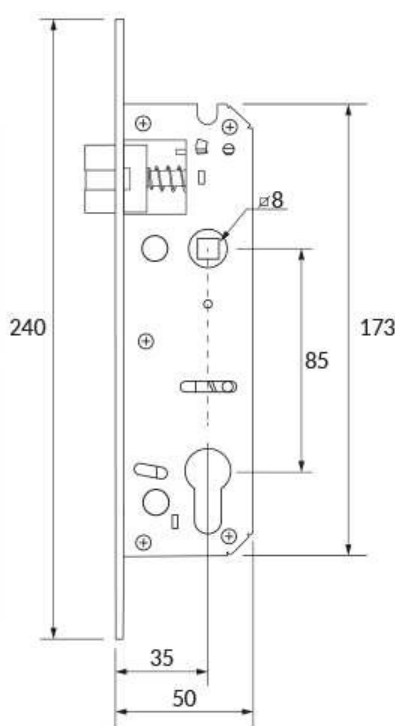
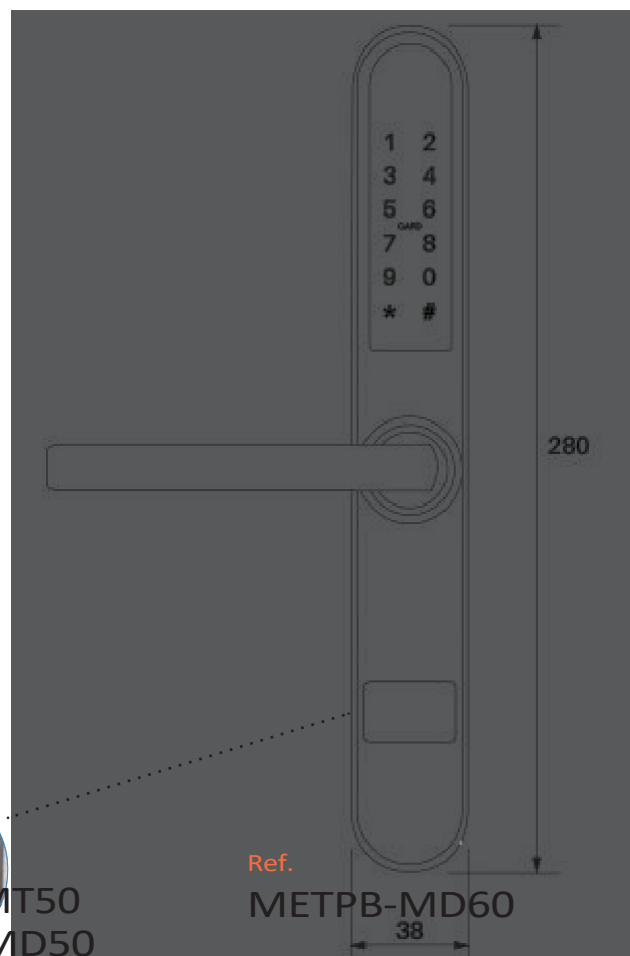

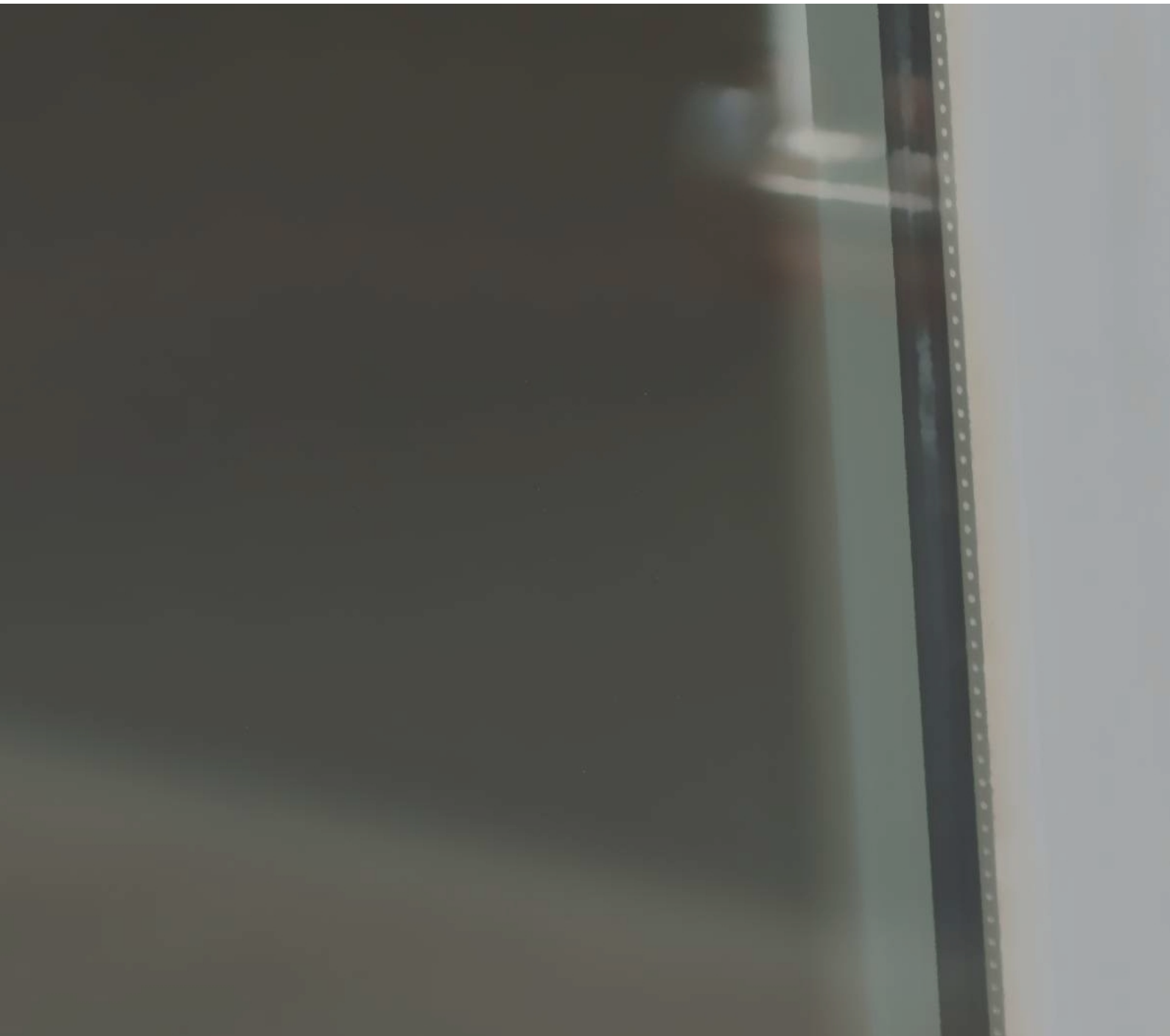

## ELECTRONIC CYLINDER



## Electronic cylinder

Ref. CIEL3030NP  
CIEL3535NP  
CIEL4040NP  
CIEL6040NP  
CIEL6040NP

### Specifications

- Complete control through: Wi-Fi (it is necessary to install a WiFi "Gateway" link point), bluetooth APP, proximity card, numerical code.
- Door thickness: between 60mm. and 125mm.
- Working voltage: 4.5V (3 batteries type AAA 1,) NOT INCLUDED.
- Material: Zinc alloy steel
- Card type: Mifare 13,56 MHz.
- Working Temperature: -20°C - 70°C
- Humidity: 10-95%.
- IP Rating: IP44
- Battery life: Approximately 10,000 opening / closing operations of the mechanism.
- Available languages: Spanish, English, French, French, Portuguese...
- FREE APP: Android and IOS
- Applications: Residences, Apartments, Offices, Hotels.  
(need management software), AirBNB, Shops, Gyms, .....

\*Hotel management software available.

### FINISHES AVAILABLE



Nickel



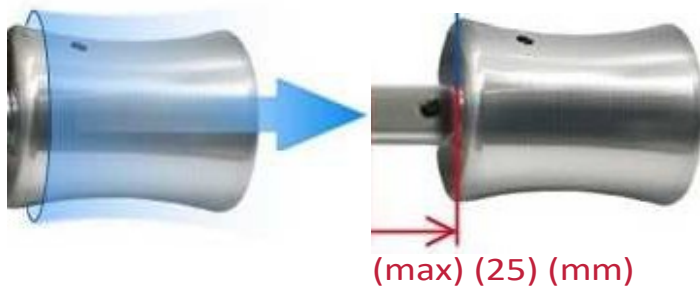
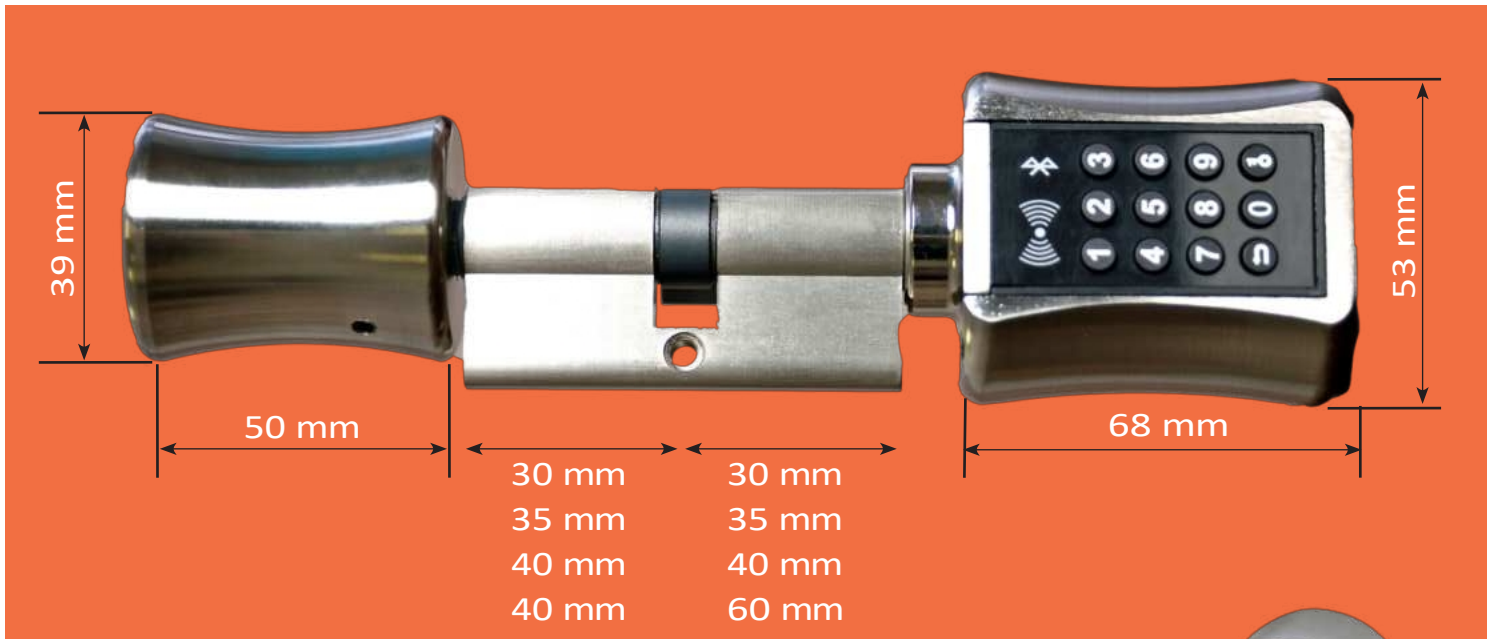

Internal knob sliding up to 25 mm (max.)



Safety opening through  
Micro USB power supply or with  
uncopyable key (2 supplied)

## Technical features

### Reader Module

- Technology of identification 13,5MHz. with RFID chip without contact.
- Low power consumption.
- Reading distance: 2-4 cm. for RF cards.

### Control Module

- Volatile memory.
- Up to 20,000 users.
- Different warning signals: low battery level, authorized access, access denied, privacy activated, door locked, etc.
- Protocol: Mifare 13,5MHz.

### Locking mechanism

- The motorized clutch activates the outer knob. When the door is closed, the inner rotor turns freely.

### Battery module

- 3 AAA type batteries LR03 1,5v.
- Estimated life: 3 years in standby mode.
- Consumption: 20μA in standby mode.
- Batteries can be easily changed without disassembling the cylinder.







## WALL READER



## Wall reader

Ref. CAMTPB



### Specifications

Numerical keypad suitable for any type of door with electric lock or electric strike.

Our CAMTPB keypad is the solution for most restricted areas.

A variety of credentials can be used to control access:

- Password up to 8 digits
- Proximity Card using Mifare 13.5MHz protocol
- From smartphone using the TTLock app available for free for IOS and Android :
  - via Bluetooth
  - via WiFi . In this case it is necessary to install a WiFi "Gateway" link point.

From the APP the access can be managed 100% :

- Access management in real time . The access period can be permanent, temporary, cyclic or single-use.
- Event log: who entered, how and at what time.
- Remote Control

### FINISHES AVAILABLE

Stainless steel



TT

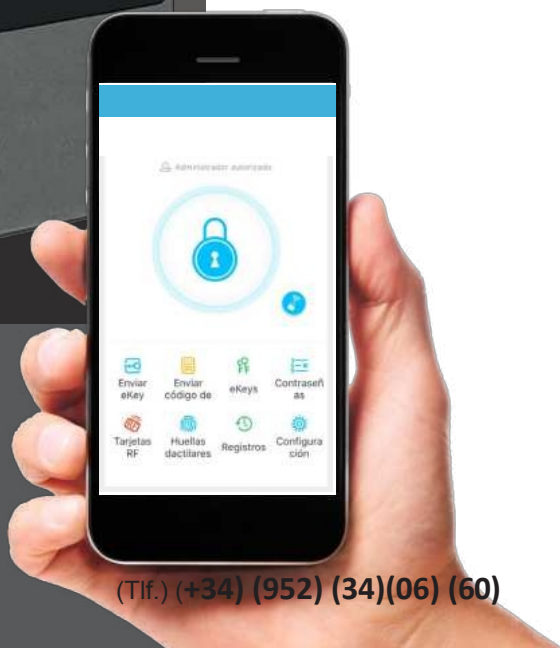

WWW.REMOCONSP.COM

(Tlf.) (+34) (952) (34)(06) (60)

(Dept.) (Technical)  
678 64 32 00



## Technical Characteristics

Material: Aluminum (body).

Front material: Tempered glass panel.

Communication: Bluetooth 4.1

Supported Systems: Android 4.3 / IOS 7.0 or higher.

Power supply: 220 V.

Output: 12 V.

IP Protection: P 66. Users:

Up to 20,000 Protocol:

Mifare 13.5 MHz

- Applications: Residences, Apartments, Offices, Hotels  
(need management software),  
AirBNB, Shops, Gyms, .....

\*Hotel management software available.

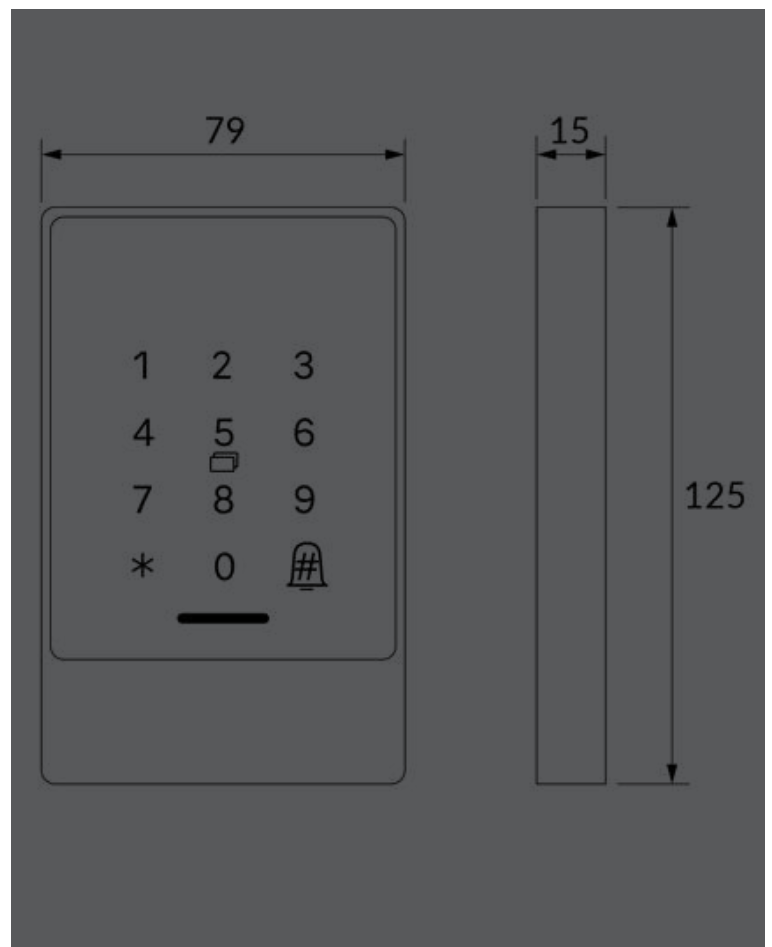



## BLUETOOTH MODULE





## Bluetooth module

Ref. **RSTRBL**



### Specifications

Bluetooth module suitable for any type of door equipped with electro-lock, electric lock or motor; our **RSTRBL** module is easy to install and is the perfect solution for most restricted areas.



The access can be done from smartphone using the application

**TTLock** available for free for IOS and Android :

- via Bluetooth
- via WiFi . In this case it is necessary to install a WiFi gateway.

From the APP access can be managed 100%:

- Access management in real time . The access period can be permanent, temporary, cyclic or one-time use.
- Event log : who entered and at what time.
- Remote Control

The administrator is the owner of the module. Only the administrator can manage it.

You can also assign authorized administrators who will have access to the configuration of the device.

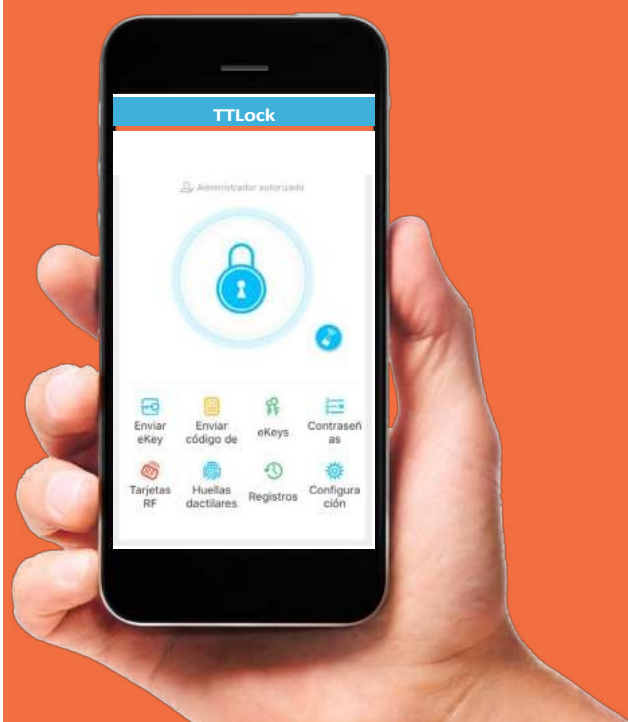



## Technical Characteristics

Connection type: Pluggable 6 pins

Interface: Bluetooth 4.0

Communication: Bluetooth or wi-fi (WiFi hotspot required)

Users: Up to 20,000

Dimensions: 64x36mm

For its use it is necessary to have a control panel or receiving base equipped with a 6-pin socket.



## Management Software



- Software - App of management for the STAFF of the hotel.
- Software - App exclusively for hotel GUESTS.
- Status and type of room.
- Check in and check out according to room status.
- Multiple interchangeable unlocking methods from the software and app.
- Possibility of reserved areas.
- Access time management.
- Collection of records with the app and possibility to search them in the PC or in the APP.
- Device management.

## Card reader / encoder

Ref. LELLPME



Card reader and decoder unit. Supports different types of cards.

- Mifare S50 protocol.
- Radio frequency 13.56MHz.
- Power supply: Usb type C.
- Power 5V/500mA
- Measures: 70 x 70 x 26 mm

## Card

Ref. LLPMEHTPB



13.56 MHz Mifare proximity cards 13.56 MHz RFID technology

Works with all our products that incorporate the Mifare proximity reader:

- MEHTPB electronic handle
- Electronic cylinder CIEL
- CAMTPB wall reader

Protection rating: IP68 Reduced size : 50 x 30 mm

## WiFi hotspot

Ref. PEWBME

The WiFi gateway, also called Gateway, is suitable for our electronic handle, electronic cylinder, wall reader and bluetooth module.

It is used together with the TTLock application, available FREE for IOS and Android.

Thanks to the WiFi hotspot, the smart lock (electronic handle, electronic cylinder or wall reader) can be unlocked / locked remotely by connecting to the TTLock application; this already provides a wider unlocking distance than that offered by Bluetooth.

At the same time, it allows :

- modify and delete eKey/Password/IC card at any time and in any location
- real-time monitoring of door lock status, battery life and operating logs.

An unlimited number of smart locks can be paired to the WiFi hotspot as long as they are within range.

It is recommended that the distance between the WiFi hotspot and the integrated lock (electronic handle, electronic cylinder or wall reader) does not exceed 100 meters, otherwise connectivity will be affected.



## Oval handle trim

Ref. EMBMEHTPB

\* handle not included

Oval trim for MEHTPB electronic handle INOX 304 Finish

Sizes 325x78 mm

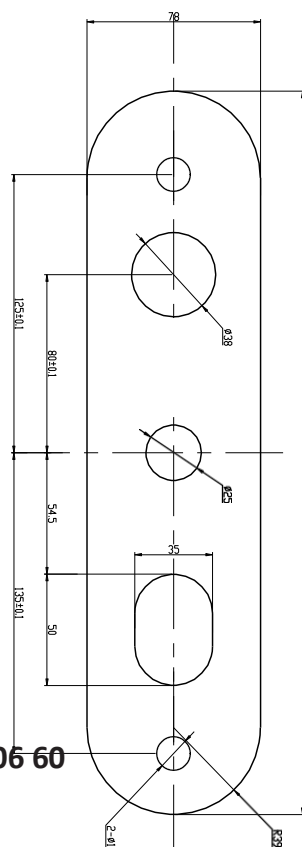

WWW.REMOCONSP.COM

Tlf. +34 952 34 06 60

(Dept.) (Technical)  
**678 64 32 00**

# With more than 30 experts at your service

WE CONNECT WITH YOU  



RemoconSP



REMOCON\_SPAIN



RemoconSP



remoconsp

Technical  
Dept.

info@remoconsp.com

678 64 32 00



## CENTRAL Málaga

C/Ignacio Aldecoa nº15

P.I.Guadalhorce 29004 -

Málaga

